

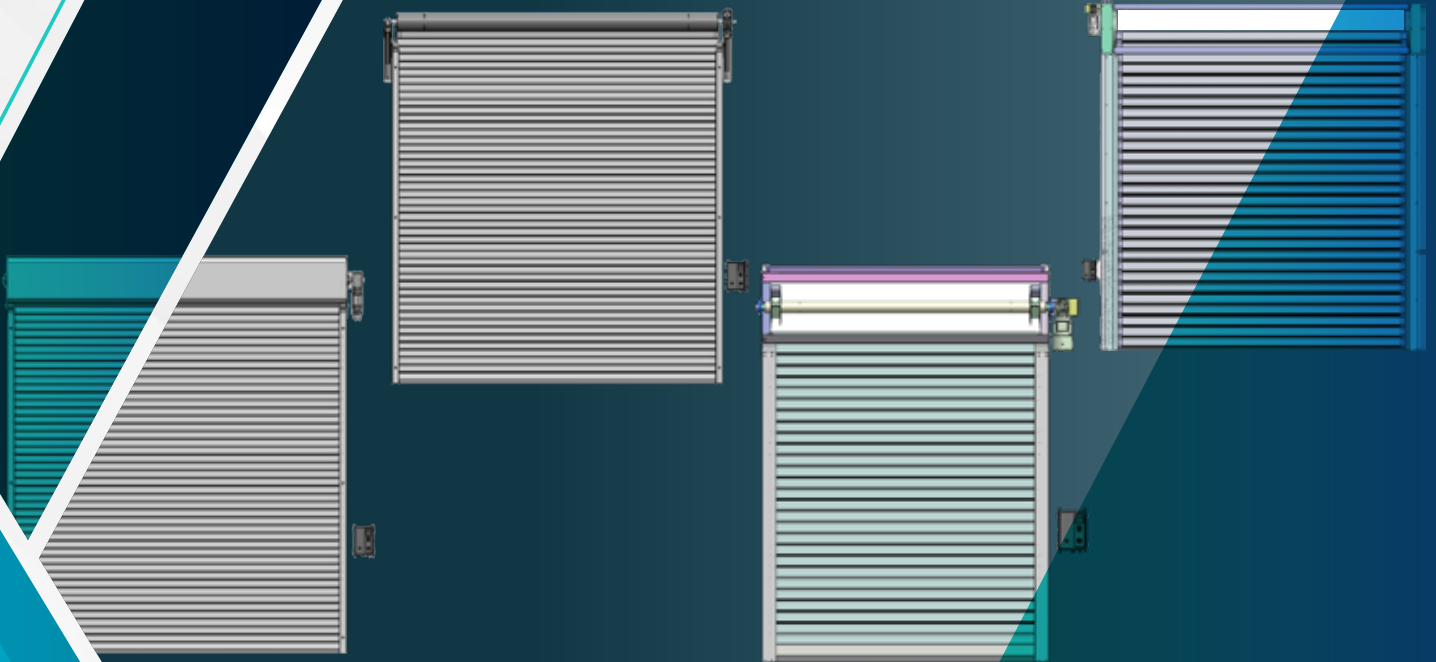

ALUMINIUM DOOR CATALOG

Speeds Up Your Business...



– www.rayflex.com.tr –

TABLE OF CONTENTS

04 - 12 — HELIXROLL

13 - 21 — SPACE100

22 - 30 — SPACE200

31 - 38 — SPACE300

ABOUT US



Rayflex High Speed Door Technology company is located in Turkey. Rayflex has become a valuable brand in the high speed door (PVC, ALUMINIUM) industry because of the high quality equipments, fast shipping term and trustworthy relationship with customer.

RAYFLEX[®] 
High Speed Door Technologies



RAYFLEX[®]
High Speed Door Technologies

HELIXROLL SPIRAL DOOR



Technical Specifications

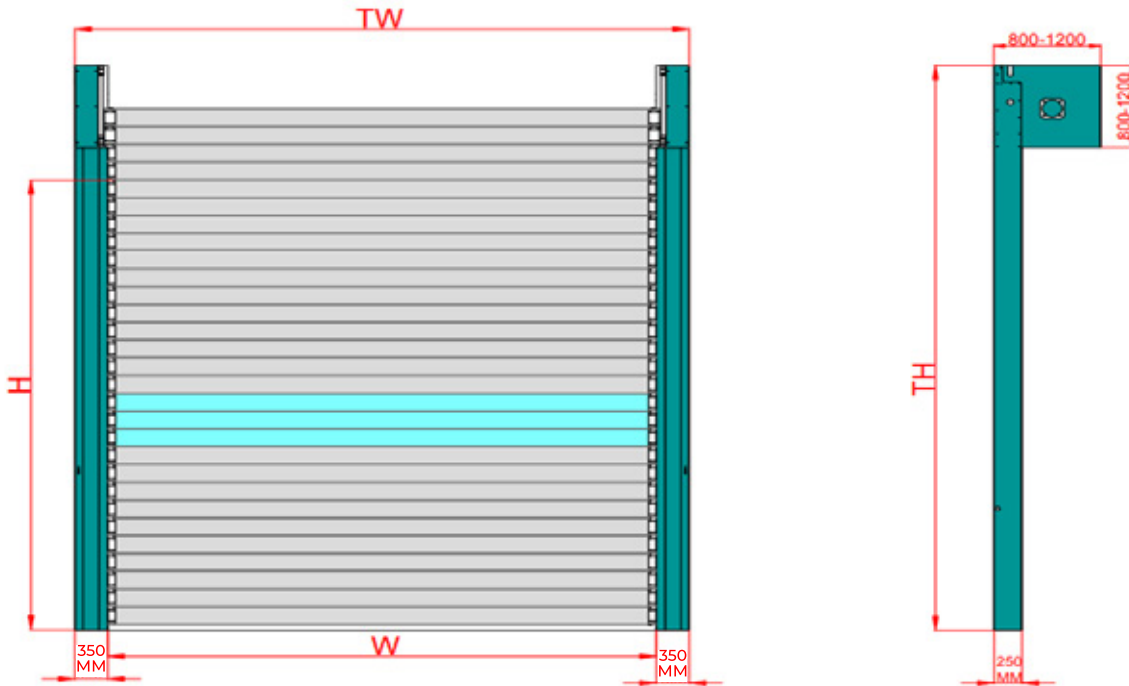

Security - Extraordinary quick spiral doors – At one door

Areas of use: Indoor and outdoor areas

Max manufacturable size : 6500x6500 mm

Metal parts: 2.5 mm special form painted guides
(metal parts are rail7016 painted in standard)

Panel: 185 mm length, 40 mm depth, outer surface painted, polyurethane filled(13-15 kg/m³) sandwich panel (clear glass can be added upon request)(can also be manufactured as full vision)

Bedding materials: Special form extruded aluminum profiles in guide and shaft group.

Engine: PGR Arçelik engine 0,75 kw-1,5 kw-2,2 kw
(It will vary depending on the size.)

Control panel: 30x40 plastic buat rf10 speed drive control panel (yilmaz) (380-380v resistant) – frequency value: 50-60 hz

Security system: Cedes light barrier

Limit system: Rayflex switch system with encoder

Speed: Can be increased up to -2mt/sec
(varies depending on size)

Wind resistance: 0-130 km/h speed resistant
(varies depending on size)

Emergency exit solution: Manual opening lever (counterweight system)



HELIXROLL

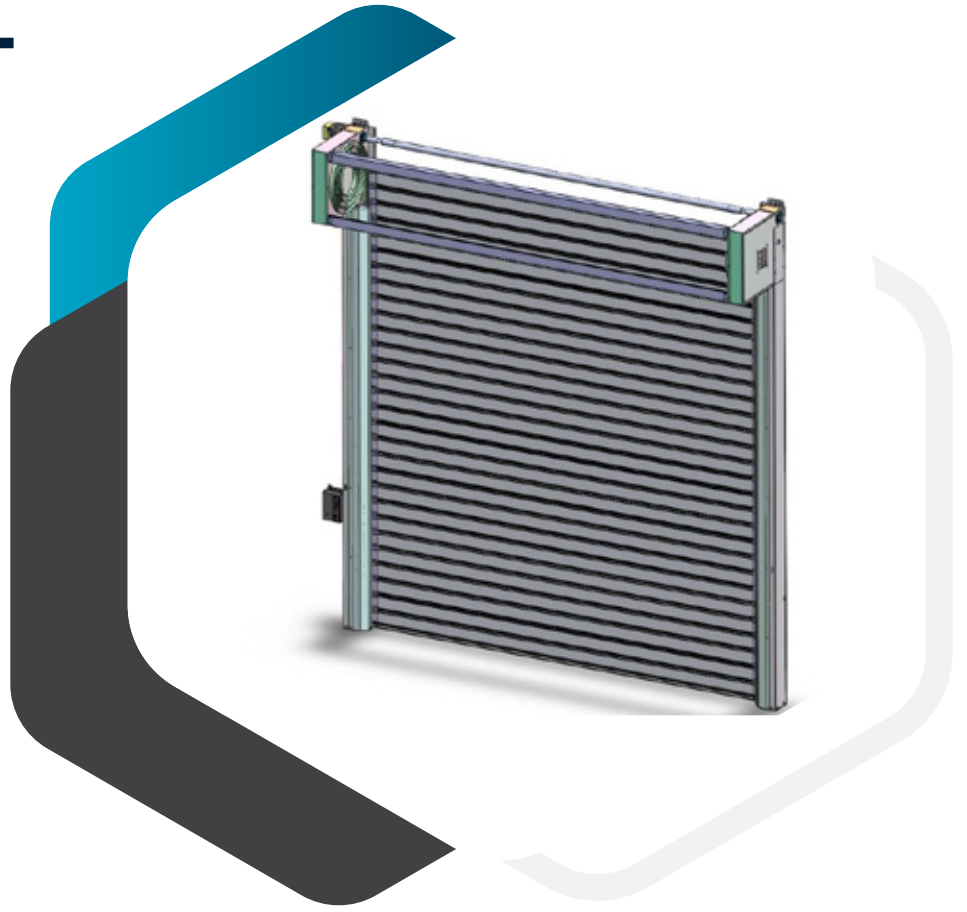

- Helixroll turbo spiral doors are preferred on the outside of the companies, in the shipping areas and in the sections with heavy transitions and also in the interior passage sections where fully transparency is required (as full vision). Helixroll provides efficiency to users by speed of working system and insulation of product.
- It makes extremely look better the manufacturing place which has heavy traffic and commercial environments. Moreover, it has a long life even in the worst weather conditions because of aluminum panel structure. Also helix technology provides silent movement even at high opening speeds.

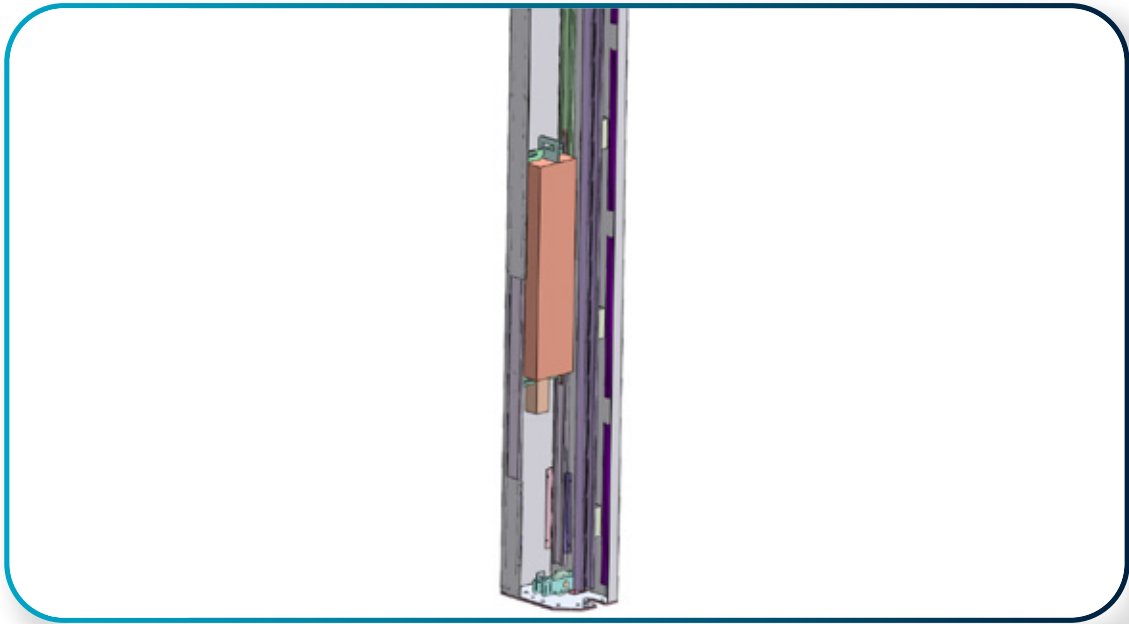

- Metal parts are formed with 2.5 mm sheets and painted with rail 7016 anthracite gray grainy as standard. The bedding group in the guide is formed from extruded aluminum profiles, and the bedding wheels mounted on the panels provide controlled descent and exit within these aluminum profiles. These aluminum profiles are connected to the sheet metal guide by means of bolts and nuts so this allowing easy replacement in case of failure. Manual opening can be easily achieved by means of the springs in the channels. Also, the carrying capacity of the engine is reduced because of to the counterweight. Therefore it is healthier for door.

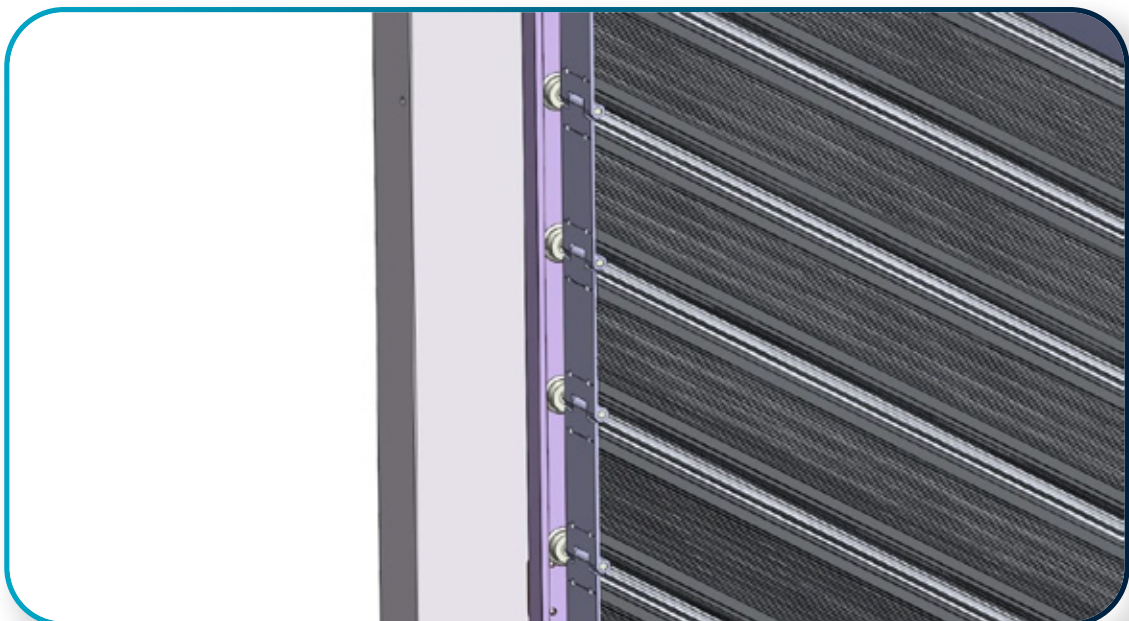

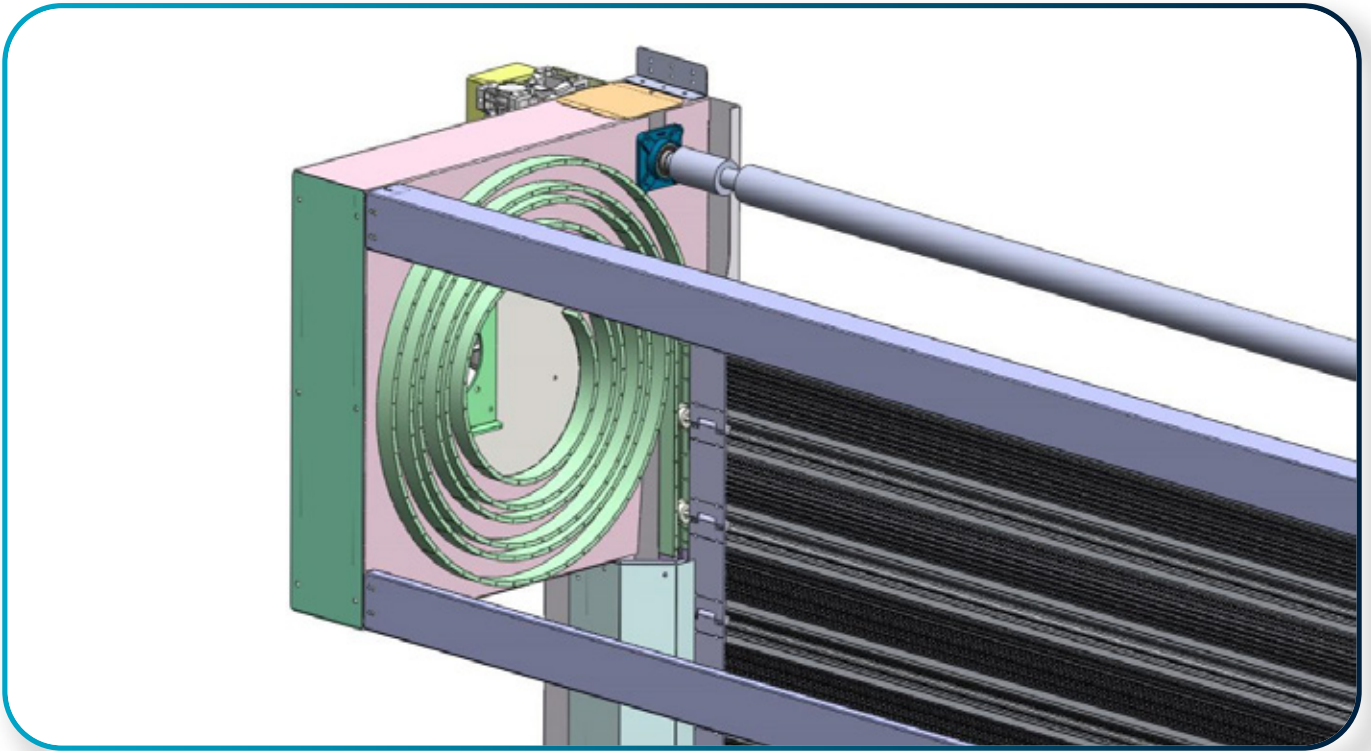

- Helixroll bearing group (spiral) has aluminum form and the continuation of the aluminum extruded profile group in the channels. Depending on the measure, spiral part's of diameter can change and collection distances may vary. Panels never come into contact with each other because of to the distance between the spiral aluminum. Therefore , the panel surfaces are not damaged and at the same time, it allows silent working opportunity.
- There are intervention covers on the Helixroll bedding group that allow easy replacement in case of failure and renewal. At the same time, there are L twist weft sheets that combine the right and left Helix spiral groups. These L-twist weft plates help the door to be mounted on the scale and ensure that it can continue to work within working tolerances.

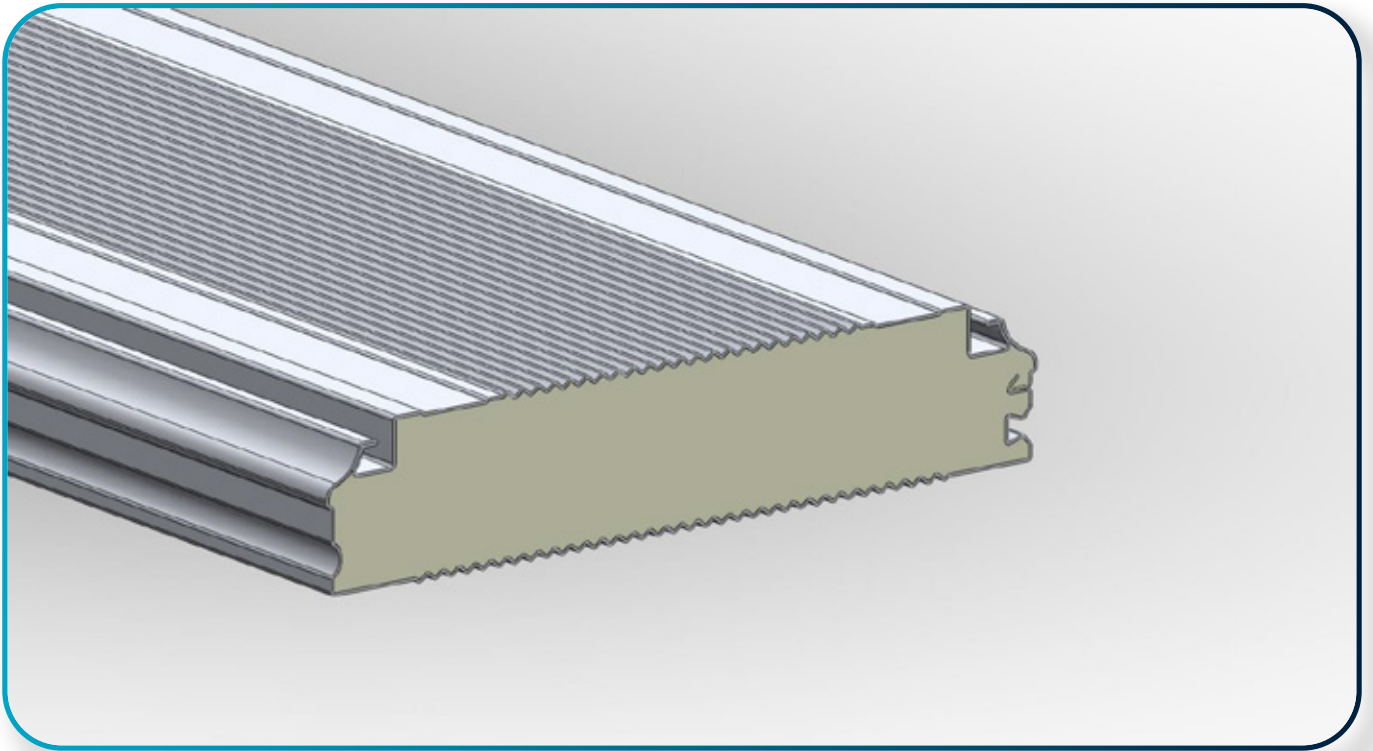

- Panel structure consisting of 1 mm aluminum sheet with polyurethane filling, 187.5 mm width and 40 mm depth, has high corrosion resistance due to the aluminum raw material. Other than that, panels with 13-15 kg/m³ polyurethane density provide sound and heat insulation.



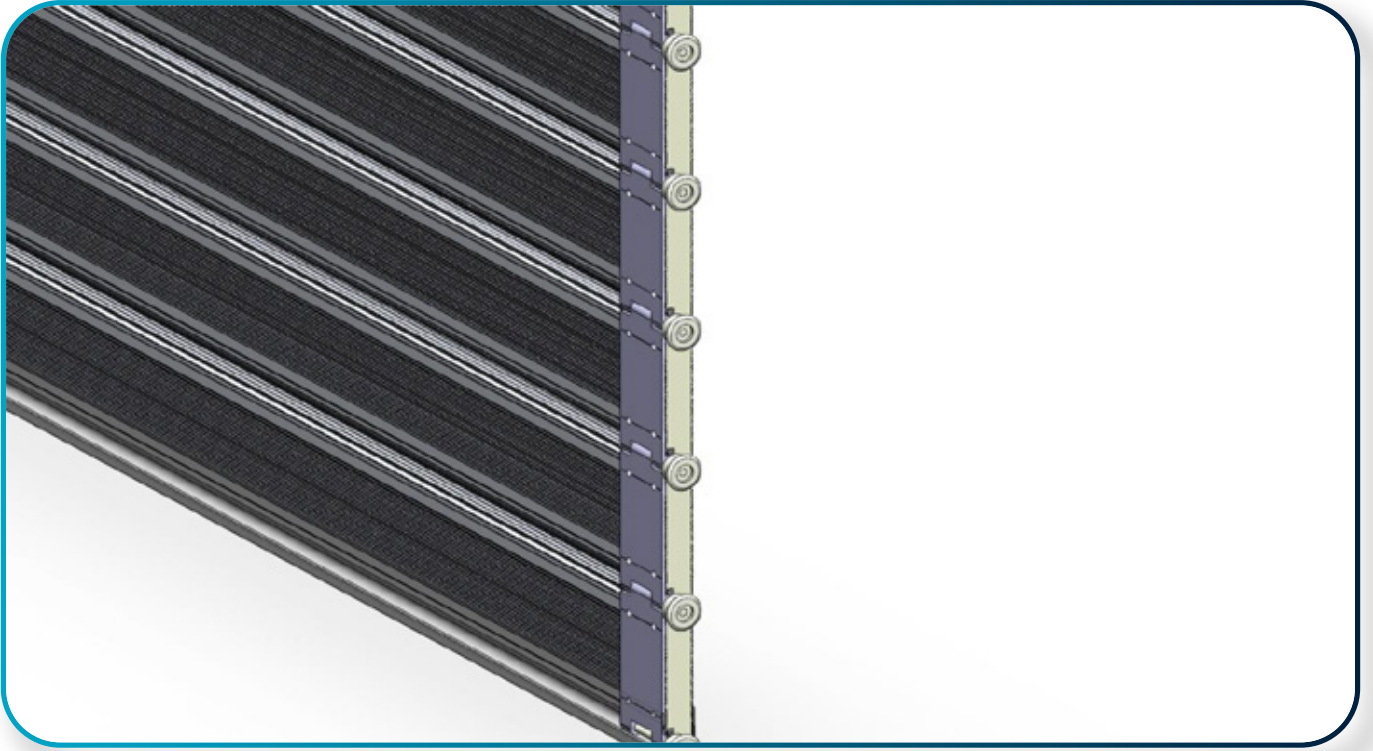

- Panel-mounted special polyethylene wheels provide bedding on the aluminum rail line. At the same time, there are hinge aluminums mounted on the panels. In order to provide sealing at the joints of the panels, the PVC seals are interlocked so this creating an elegant appearance. In addition, there are wicks on the surface areas where the panels come into contact with each other and these wicks prevent the two aluminum panels from contacting each other and also they are allowing silent operation and increasing the insulation.

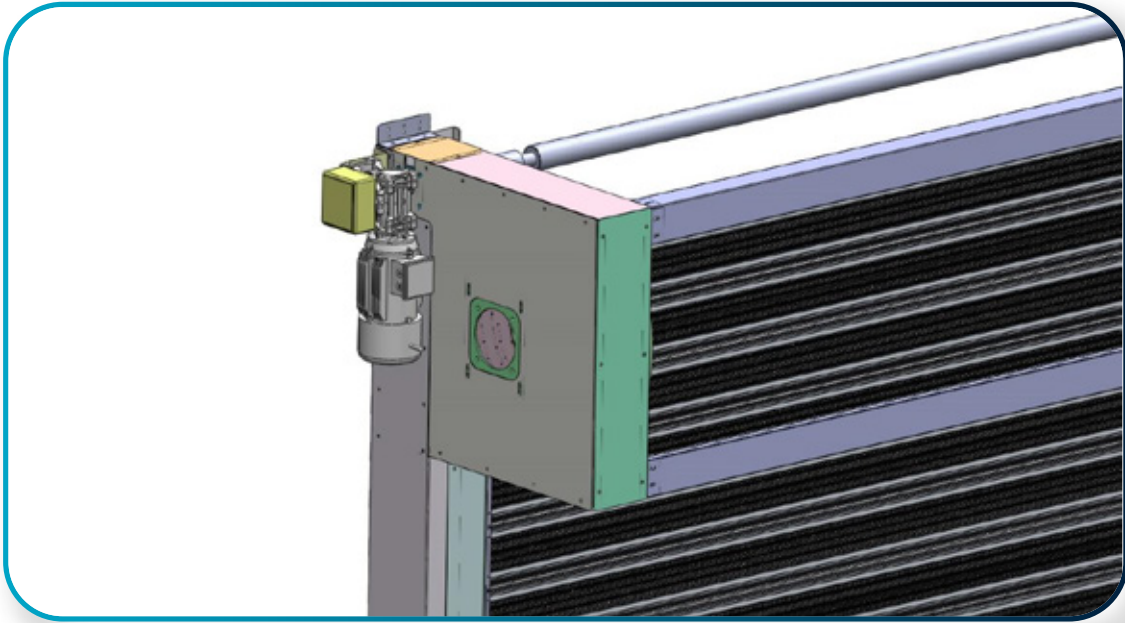

- Automation group consists of engine, switch group with encoder, control unit with 380v inverter and in-line photocell.
- The motor is selected according to its measurement values and can be selected between power values (0.75 kW, 1.5 kW, 2.2 kW). The special Rayflex switch encoder group integrated into the engine provides a stable stop and start opportunity. Because of control unit with inverter, controlled opening and closing is provided and reduces the wear rate of the door. At the same time, the speed of the door can be increased or decreased up to certain rates by changing the frequency values with the speed driver.

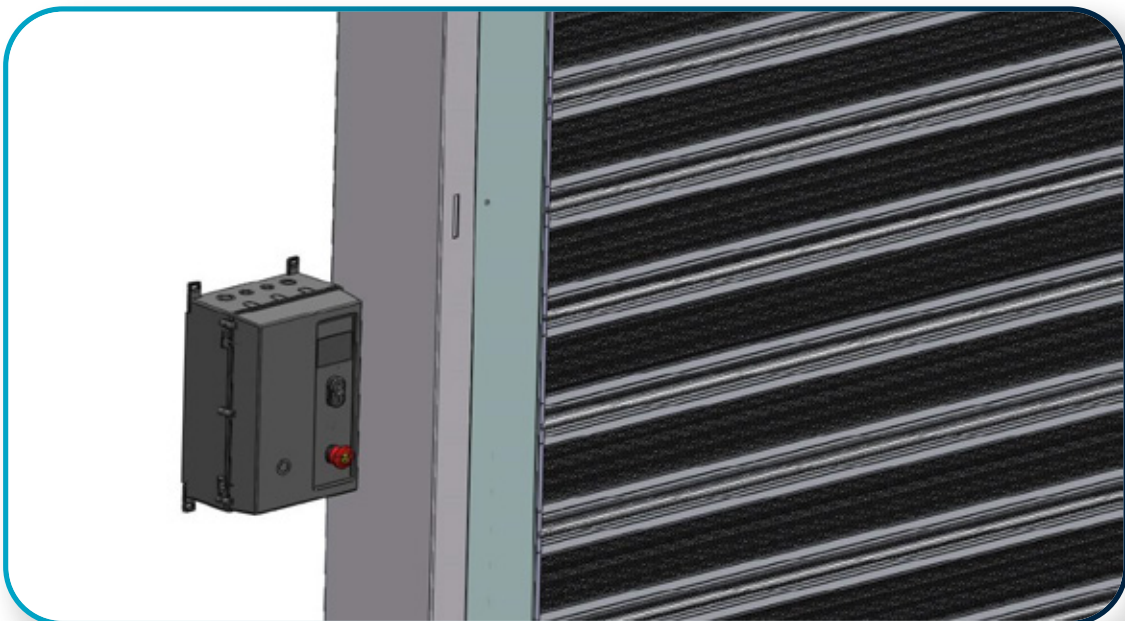



Additional Features

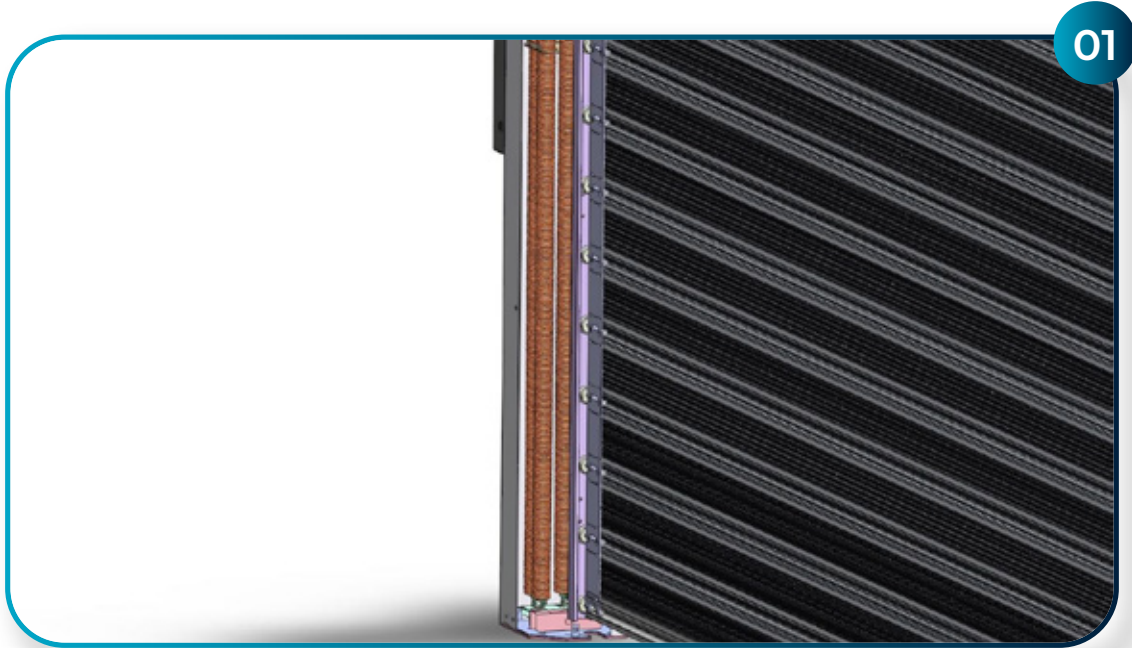

If the door needs to be opened quickly in case of a power cut, a spring system may be preferred.

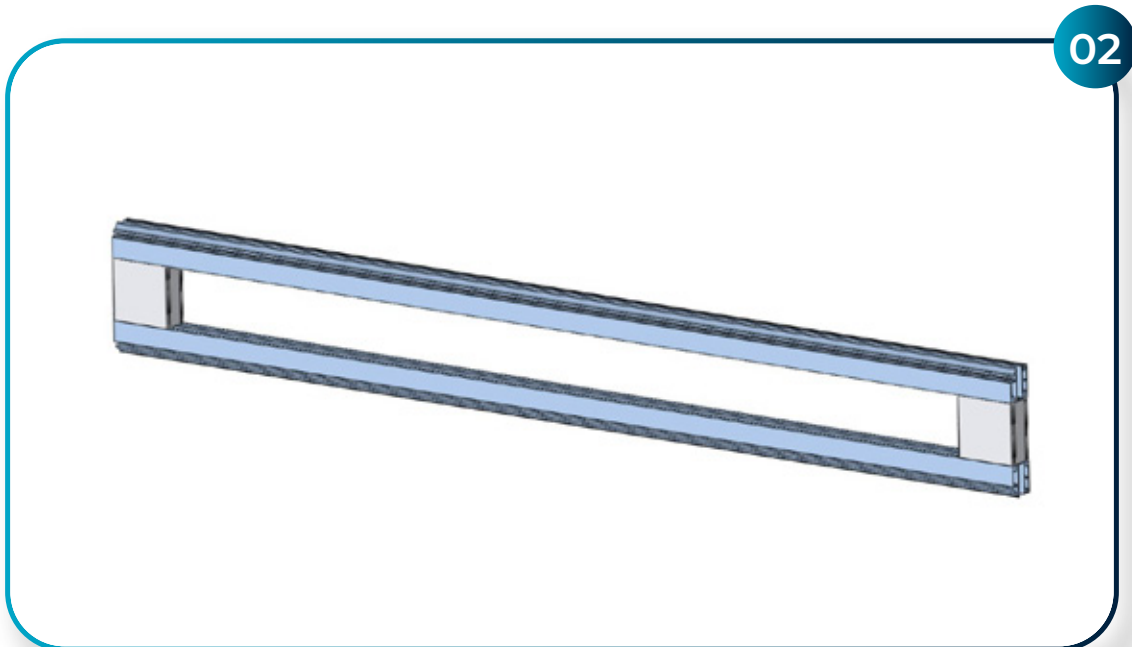

The window is made using optional special glass profile aluminum. The number can be increased upon request.

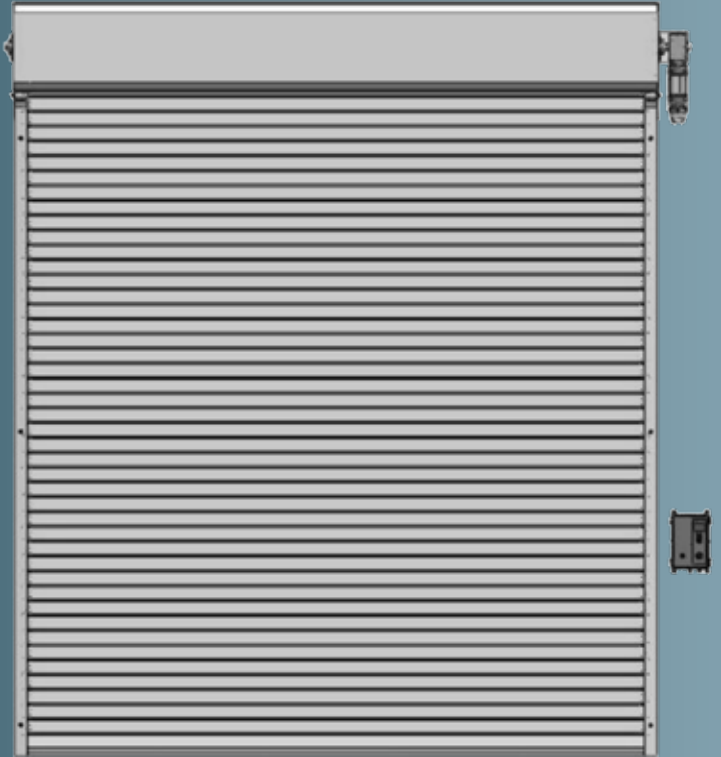

RAYFLEX[®] 
High Speed Door Technologies

**SPACE100
SPIRAL
DOOR**



Technical Specifications

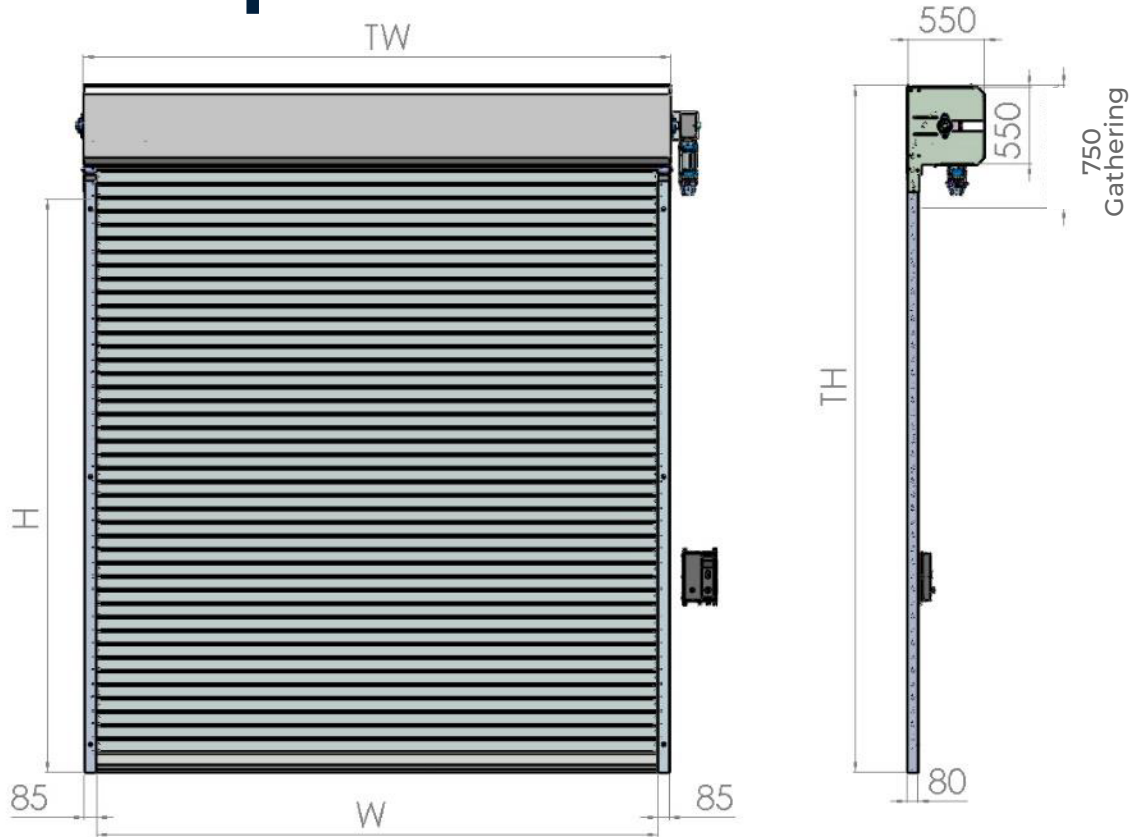

Security - Extraordinary quick spiral doors – At one door

Areas of use: Indoor and outdoor areas

Metal parts (Pillars): It has 85 mm wide special roll-form galvanized pillars. Also, there is a PVC wick and panel bearing wedge to prevent friction.

Panel: Panel are made by double-walled aluminum panels filled with rock wool and it has 100 mm wide and 22 mm deep.

Engine: PGR Arçelik engine 0,75 kw-1,5 kw-2,2 kw
(It will vary depending on the size.)

Control panel: 30x40 plastic buat RF10 speed drive control panel (yilmaz) (380-380v resistant) – frequency value: 50-60 hz

Security system: Cedes light barrier

Limit system: Rayflex switch system with encoder



SPACE100

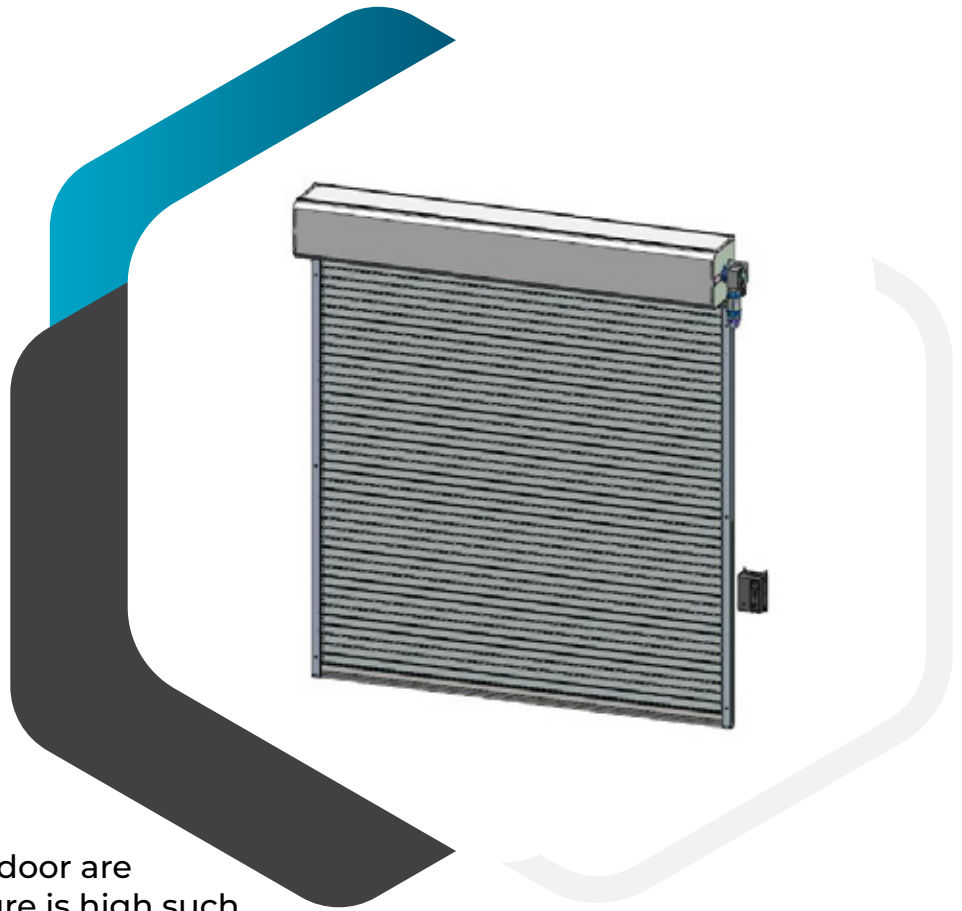

- Space100 fast aluminium door are used where the wind pressure is high such as garage doors, elevators doors, oven cabins etc.
- It provides efficiency to the clients because of the opening and closing speed and it provides insulation.
- Space100 will take your appearance and efficiency to the next level because of the spectacular looks that space100 have.
- The pillars have special PVC wicks and these wicks prevent the aluminum panels from rubbing against the metal. Also, the door works very quietly because of wicks.
- The panels are made on a special rollform machine. The production is completed by interlocking double-wall panels (1 mm thick).
- The polyurethane printing process are made by double-walled panels taken from the rollform machine. That increasing the strength of the double-walled panel. (If the door used in front of the oven cabin, the double-wall are produced by rock wool filling.)
- The flag group, where the shaft group is assembled, is manufactured from 5mm sheet metal on the laser cutting machine according to the wrapping size.
- The plugs used on the edges of the panels are 10 mm thick and enable silent operation within the bedding system.



Panel Structure

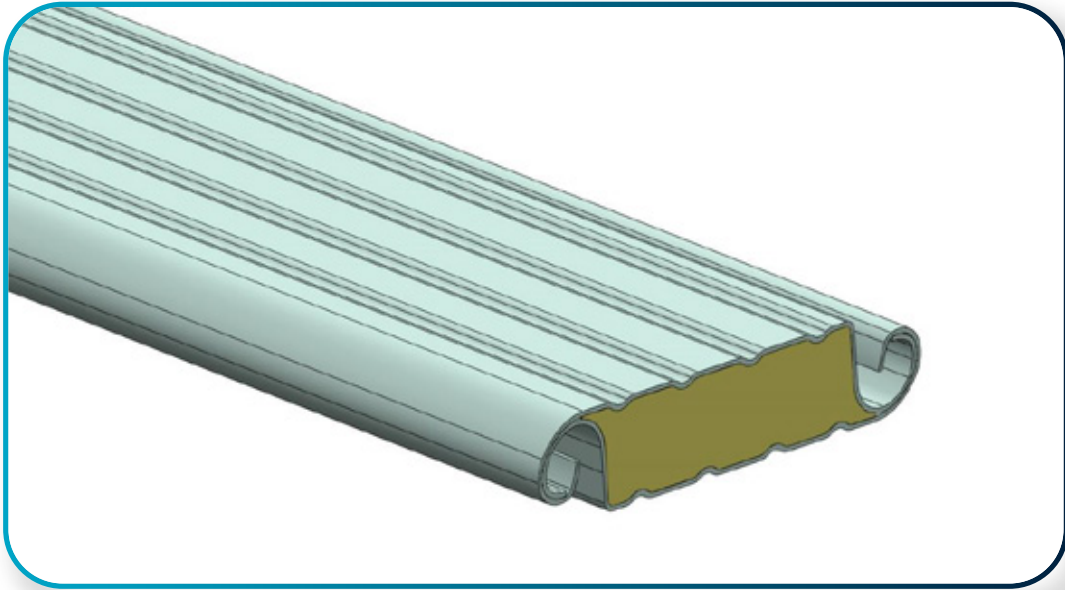

Panel Size Details

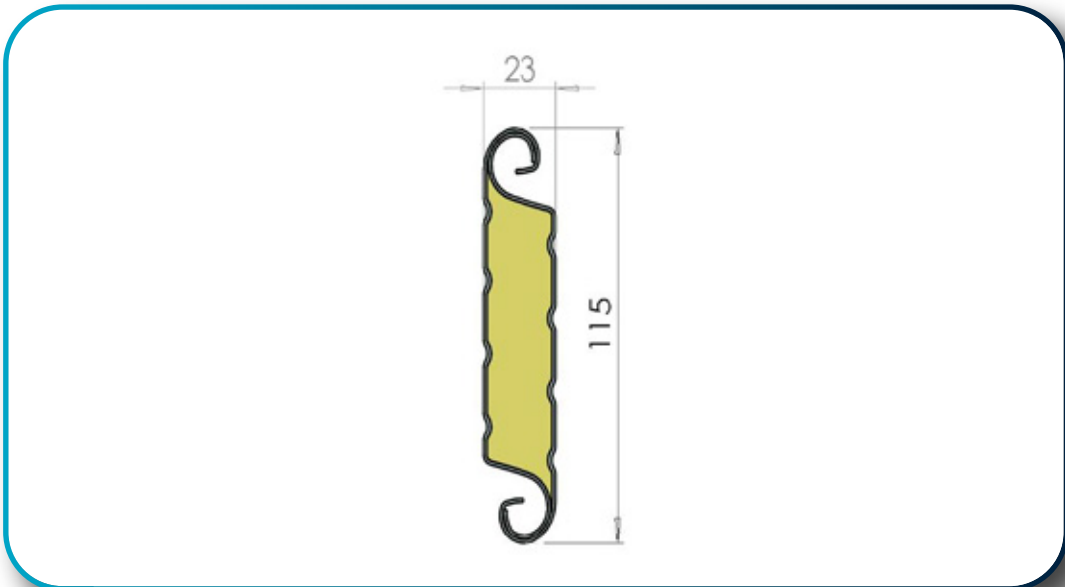

- It has a panel structure consisting of 1 mm aluminium sheet with polyurethane filling (rock wool filling if applied in front of the oven cabinet) with dimensions of 115 mm in width and 23 mm in depth.

In addition, the panel structure stands out with its high corrosion resistance thanks to the raw material being aluminium, its ease of bearing construction thanks to its low specific weight.

Panels with a depth of 23 mm provide high sound and heat insulation and ensure companies' energy savings.



Material Explanation

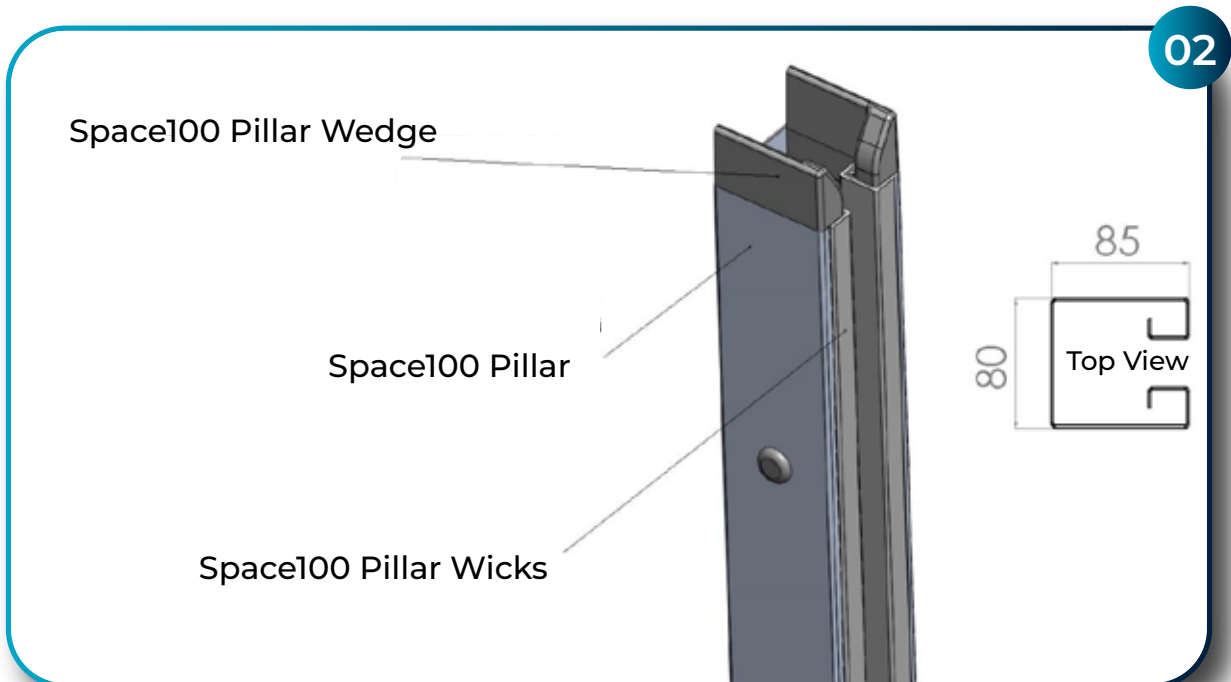
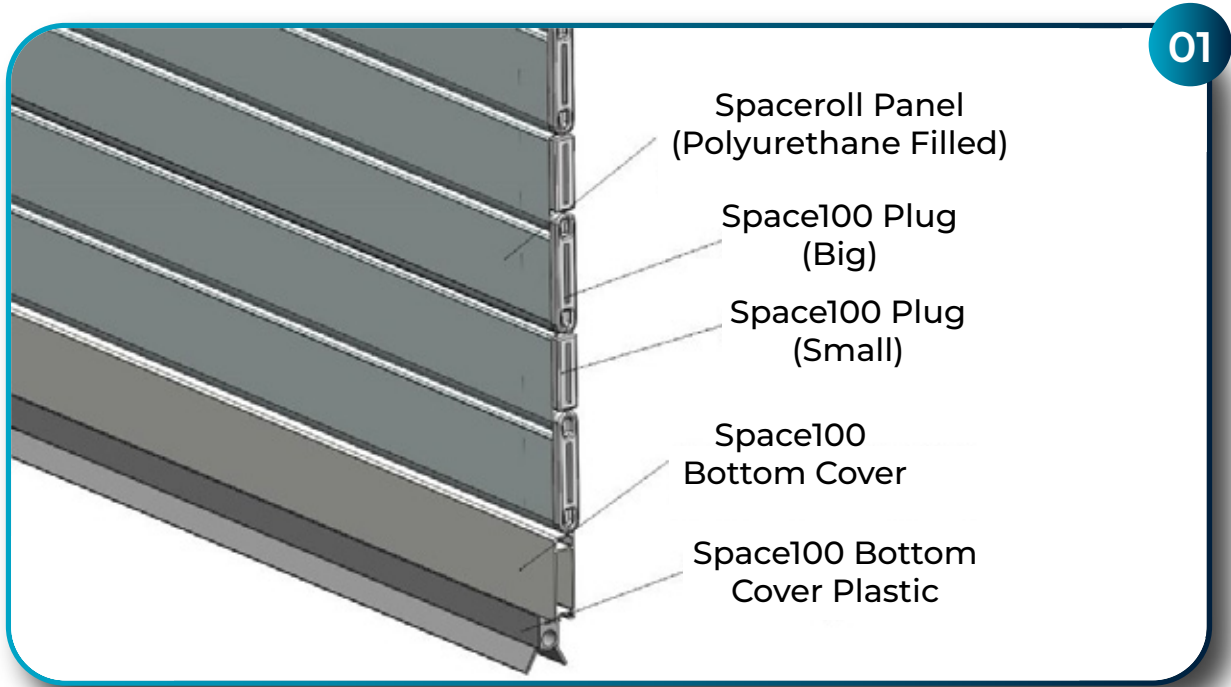



Material Explanation

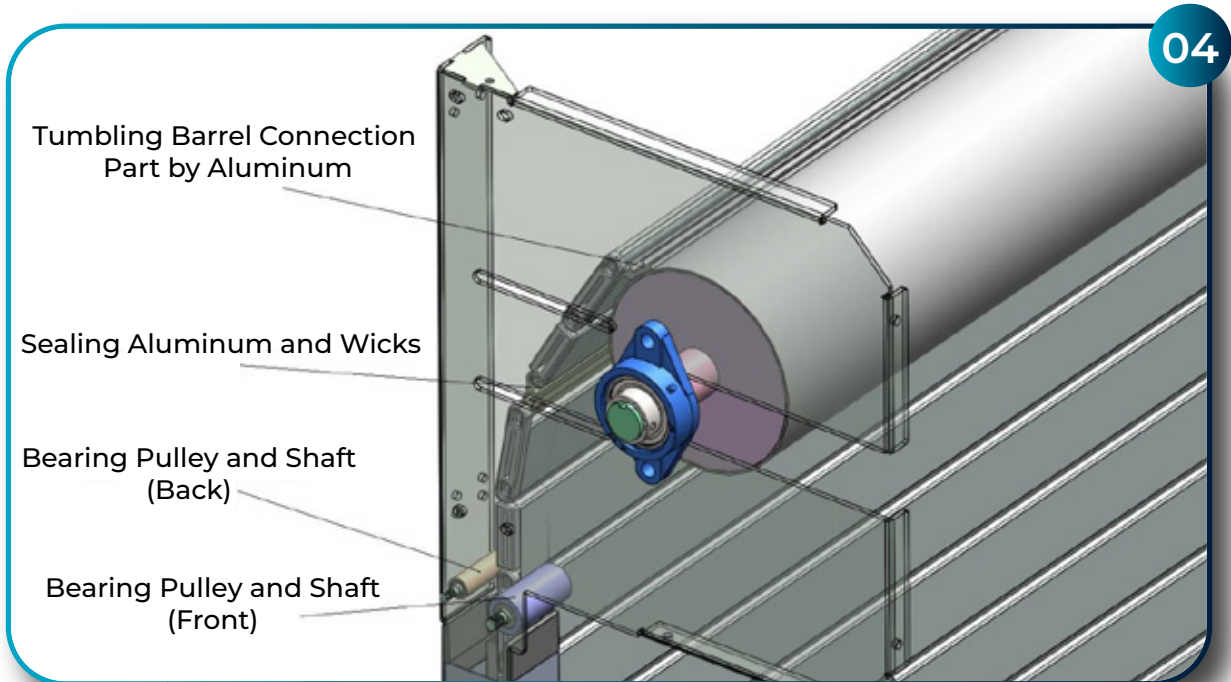
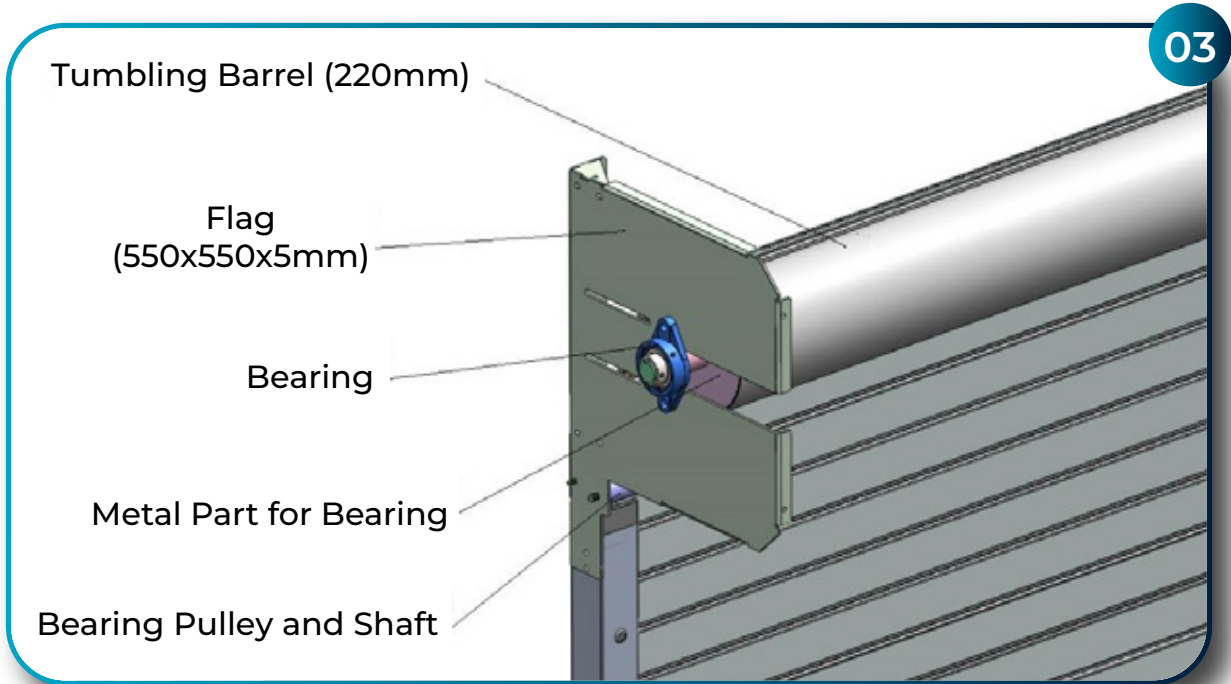



Material Explanation

05

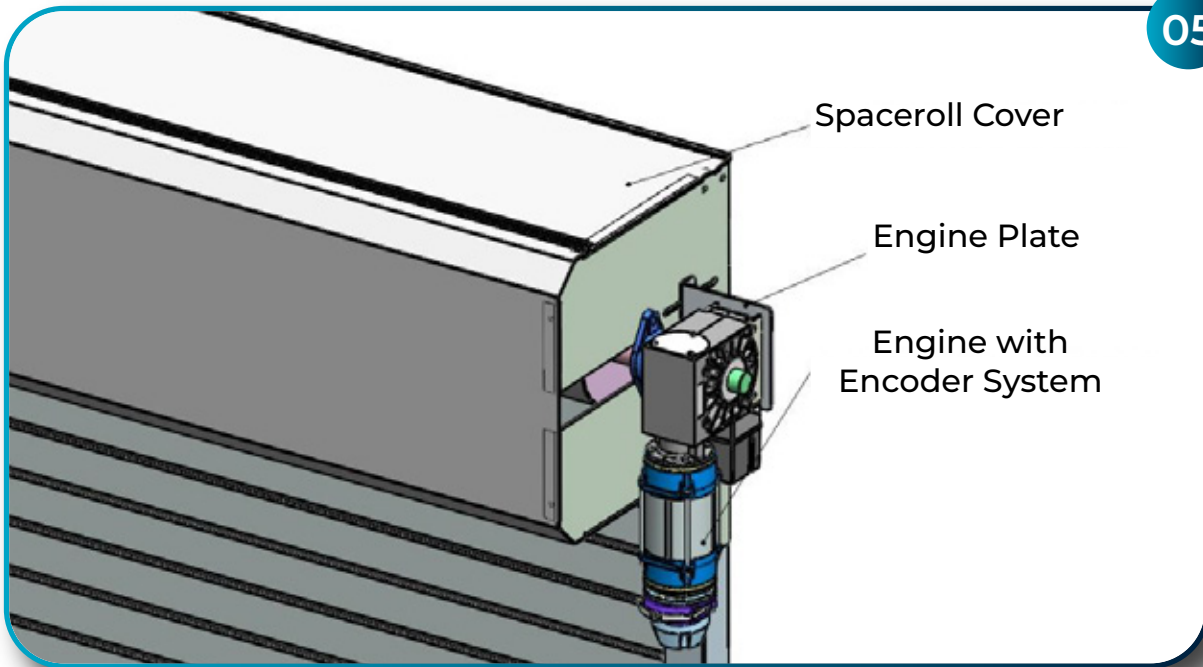

06

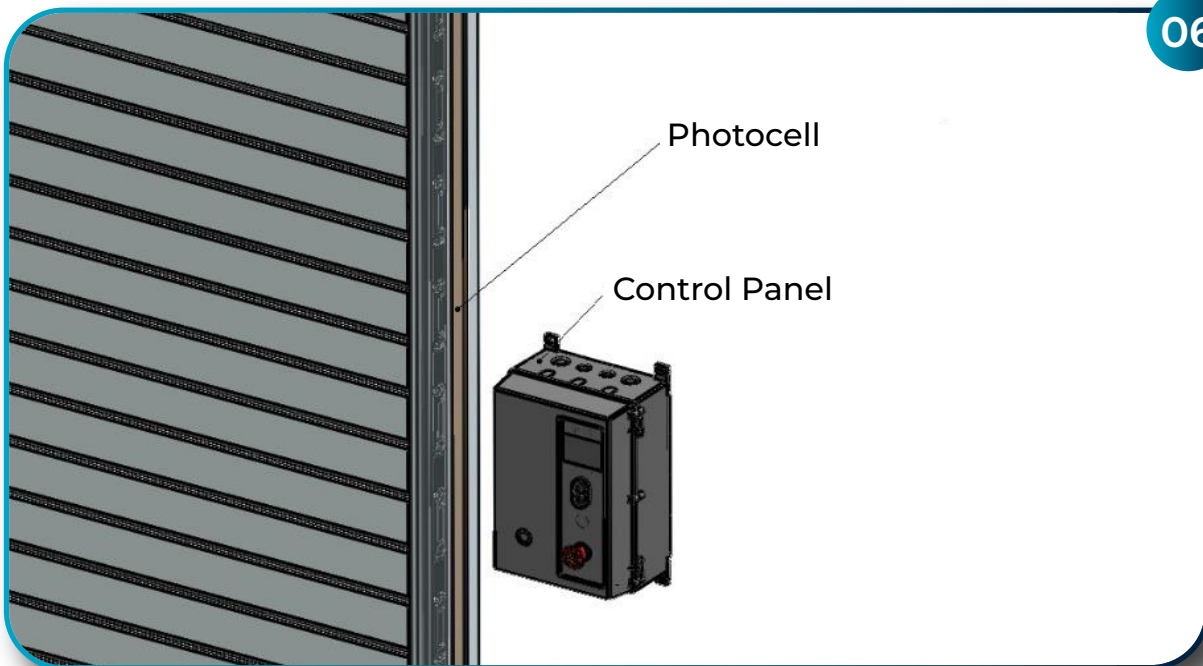



Additional Features

If the Window Required

01

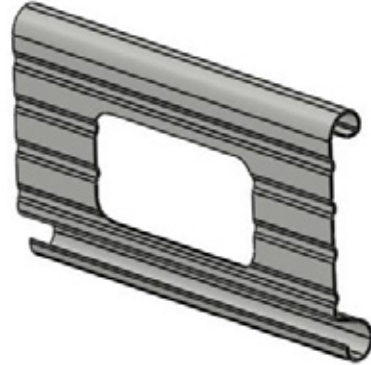
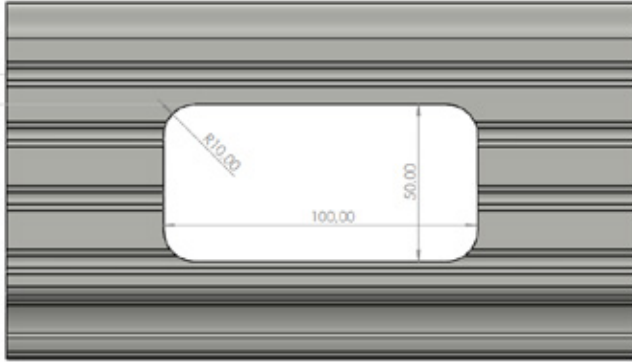

Windows can be opened on double-walled aluminium panels with a width and height of 100x50 mm, at regular intervals depending on the length of the panel.

In this way, it is possible to illuminate the desired number of panels in places where a transparent appearance is desired.

Wind Lock System

02

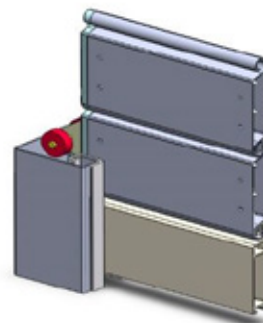
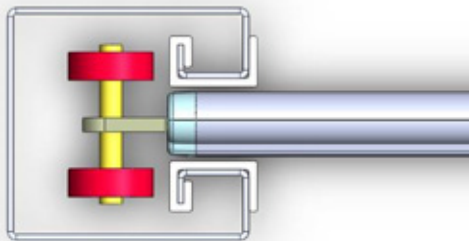

The system, which can be applied according to wind and pressure conditions, holds the extra bearing wheels used thanks to the form of the guides and is applied as a strength increasing system.



Wiring Diagram

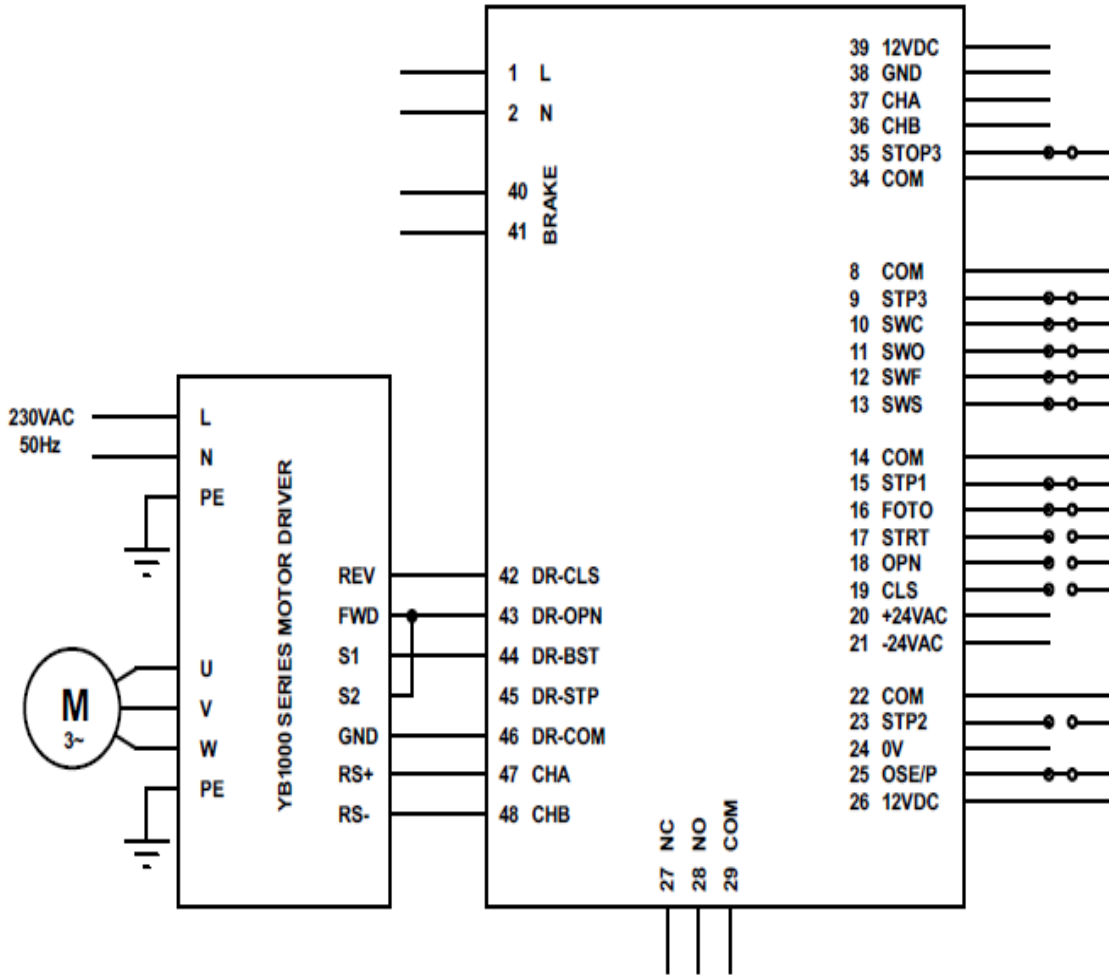

Scan the QR code to access the panel user manual and parameter setting menu.

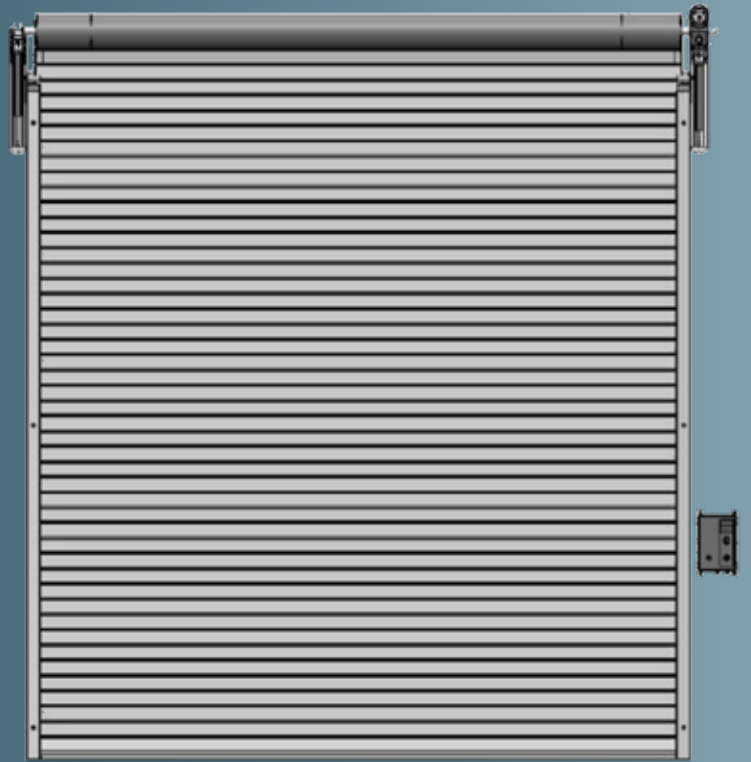

RAYFLEX[®] 
High Speed Door Technologies

SPACE200 SPIRAL DOOR



Technical Specifications

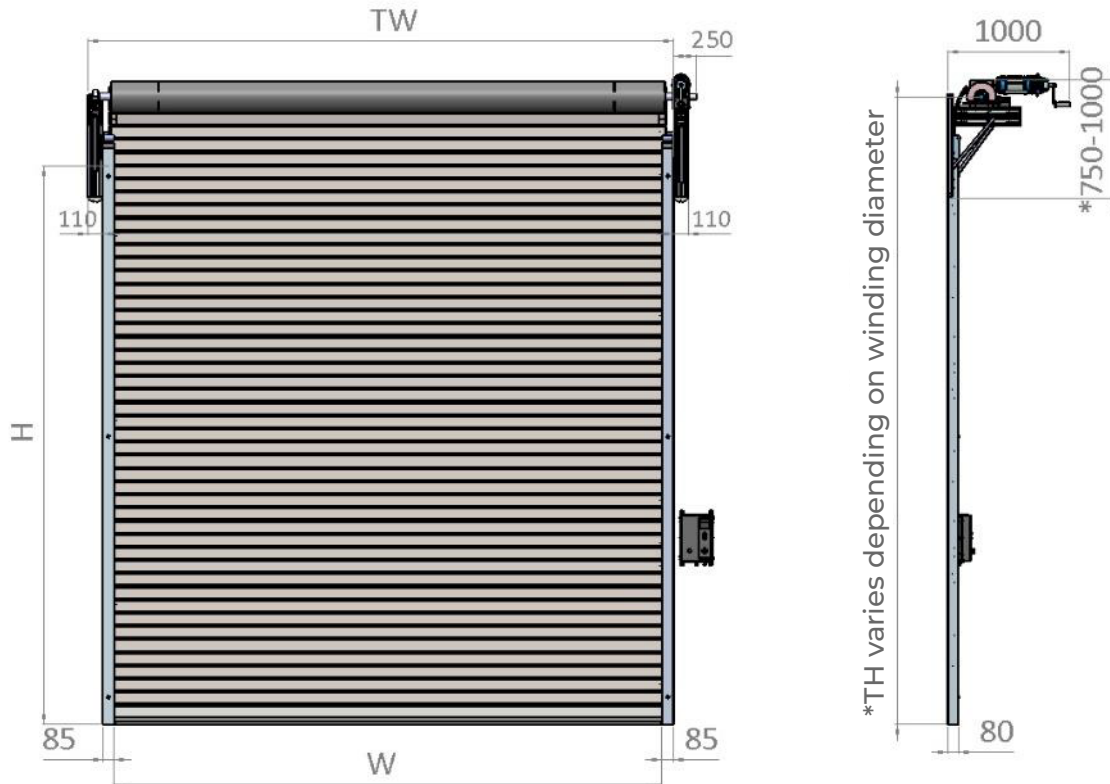

*IT VARIES DEPENDING ON THE DOOR WINDING DIAMETER. DEPENDING ON THE DOOR HEIGHT, THE MINIMUM COLLECTION IS 750 MM AND THE MAXIMUM COLLECTION IS 1000 MM.

Security - Extraordinary quick spiral doors – At one door

Areas of use: Indoor and outdoor areas

Metal parts (Pillars): It has 85 mm wide special roll-form galvanized pillars. Also, there is a PVC wick and panel bearing wedge to prevent friction.

Panel: Panel are made by double-walled aluminum panels filled with rock wool and it has 100 mm wide and 22 mm deep.

Engine: PGR Arçelik engine 0,75 kw-1,5 kw-2,2 kw
(It will vary depending on the size.)

Control panel: 30x40 plastic buat RF10 speed drive control panel (yilmaz) (380-380v resistant) – frequency value: 50-60 hz

Security system: Cedes light barrier

Limit system: Rayflex switch system with encoder



SPACE200

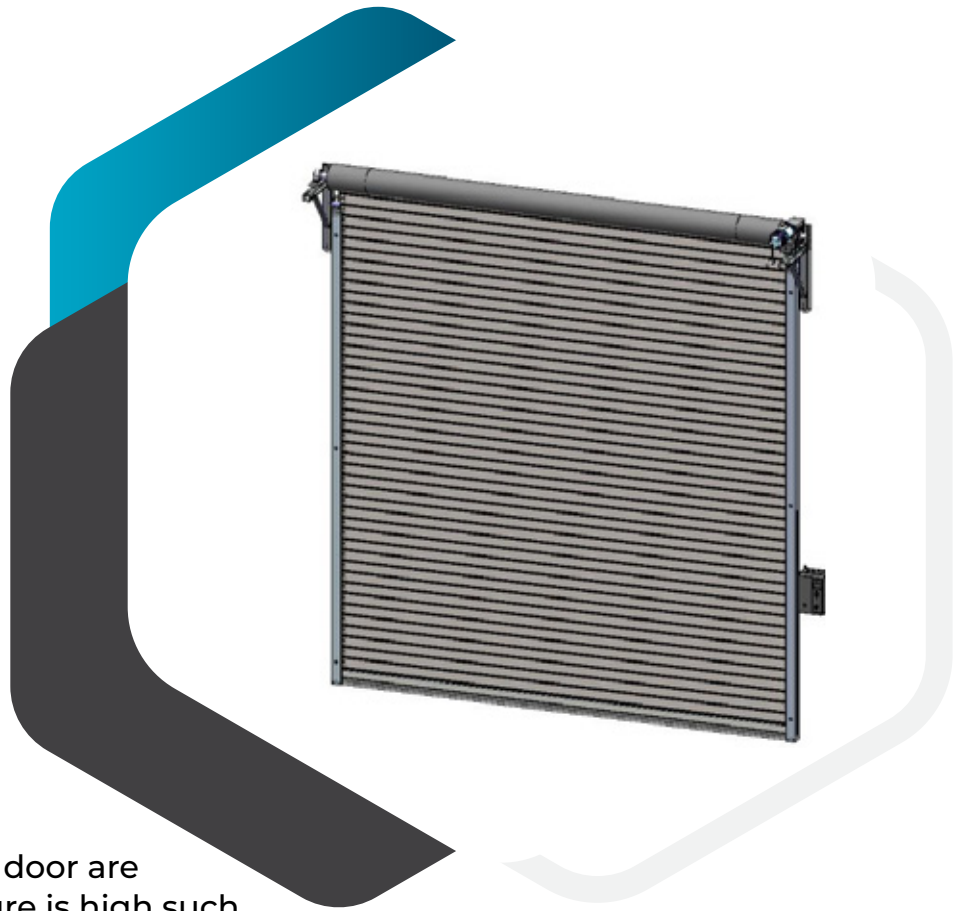

- Space200 fast aluminium door are used where the wind pressure is high such as garage doors, elevators doors, oven cabins etc.
- It provides efficiency to the clients because of the opening and closing speed and it provides insulation.
- Space200 will take your appearance and efficiency to the next level because of the spectacular looks that space200 have.
- The pillars have special PVC wicks and these wicks prevent the aluminum panels from rubbing against the metal. Also, the door works very quietly because of wicks.
- Thanks to its carrier console set (shaft group), it allows smoothly use in large sizes. The shaft group moves forward and backward as the winding diameter increases and decreases, thus providing quiet operation. At the same time, the service life is extended by reducing the friction of the panels against the pillars.
- The panels are made on a special rollform machine. The production is completed by interlocking double-wall panels (1 mm thick).
- The polyurethane printing process are made by double-walled panels taken from the rollform machine. That increasing the strength of the double-walled panel. (If the door used in front of the oven cabin, the double-wall are produced by rock wool filling.)
- The flag group, where the shaft group is assembled, is manufactured from 5mm sheet metal on the laser cutting machine according to the wrapping size.
- The plugs used on the edges of the panels are 10 mm thick and enable silent operation within the bedding system.



Panel Structure

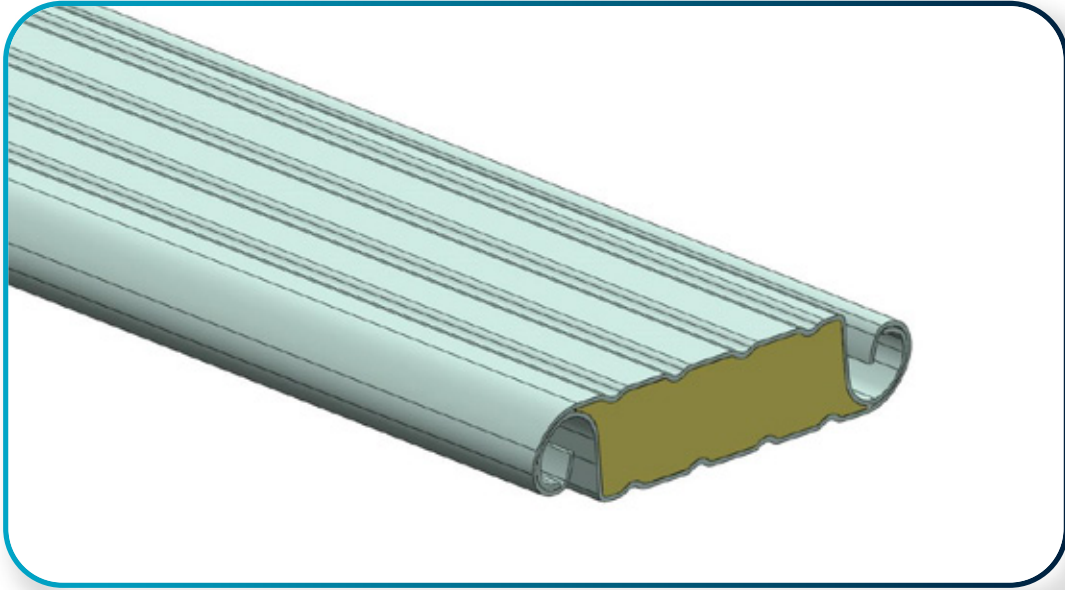

Panel Size Details

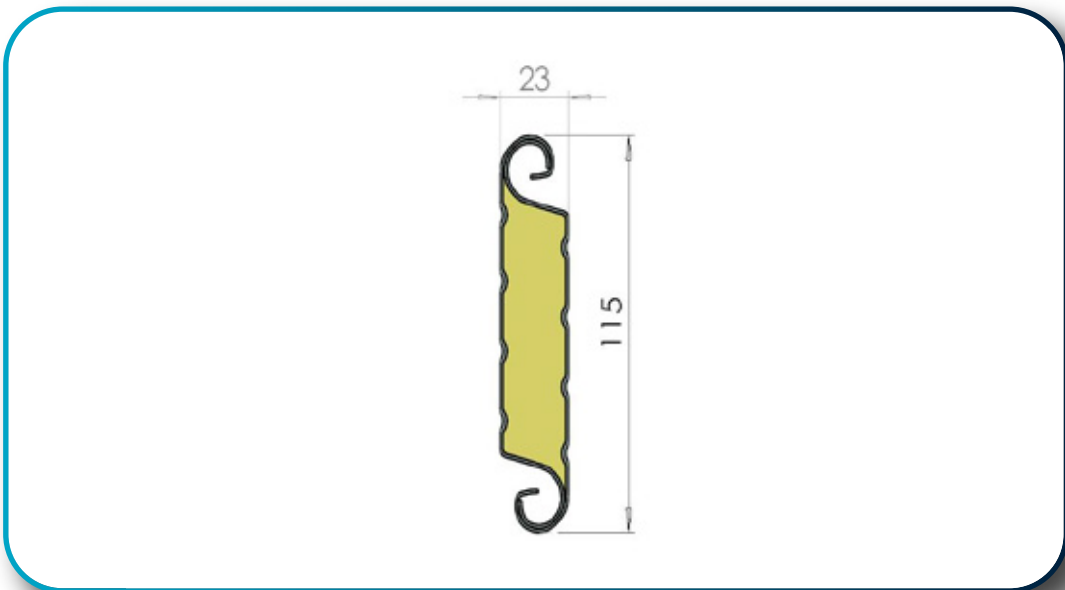

- It has a panel structure consisting of 1 mm aluminium sheet with polyurethane filling (rock wool filling if applied in front of the oven cabinet) with dimensions of 115 mm in width and 23 mm in depth.

In addition, the panel structure stands out with its high corrosion resistance thanks to the raw material being aluminium, its ease of bearing construction thanks to its low specific weight.

Panels with a depth of 23 mm provide high sound and heat insulation and ensure companies' energy savings.



Material Explanation

01

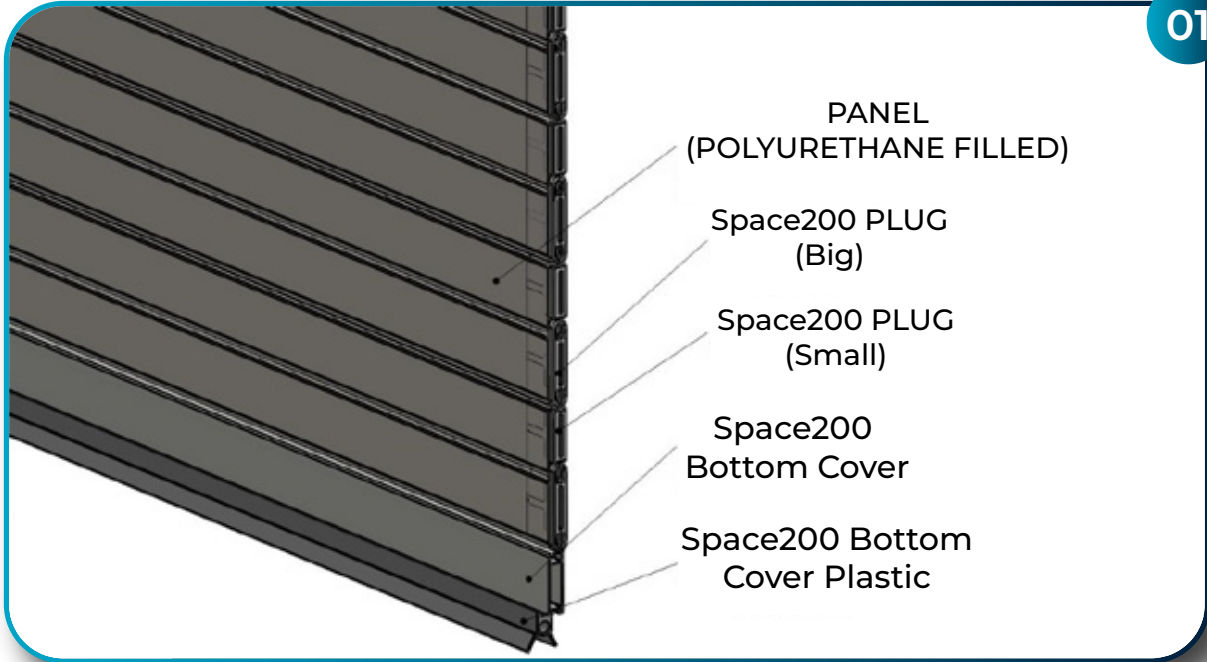

02

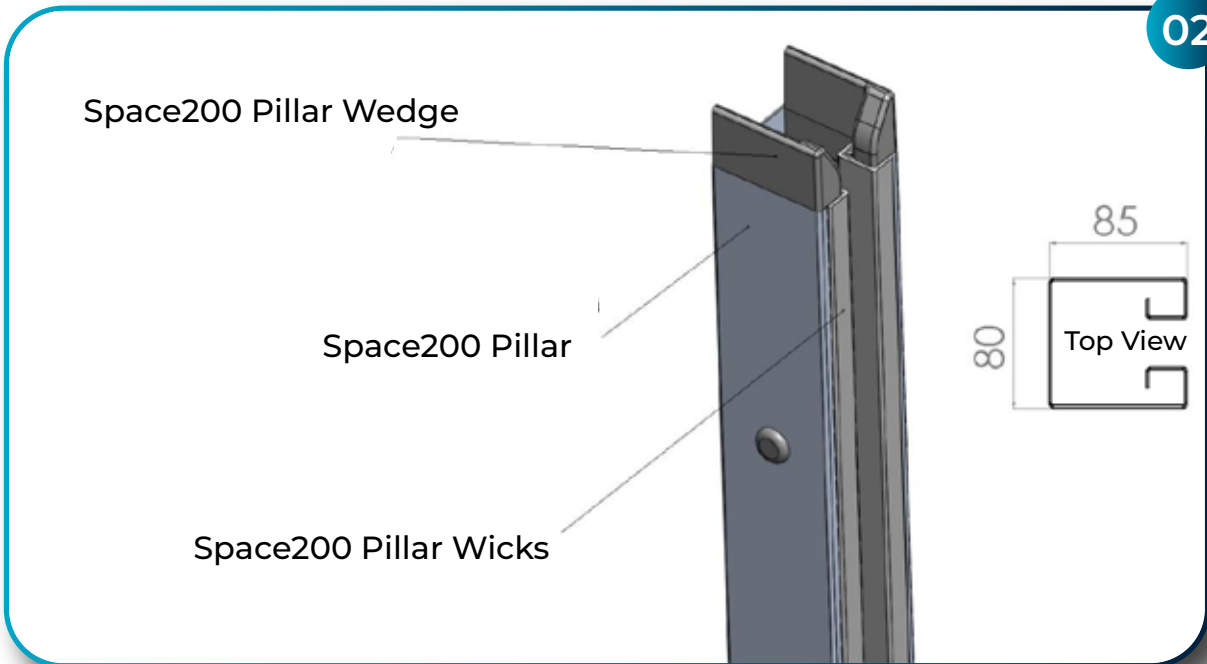



Material Explanation

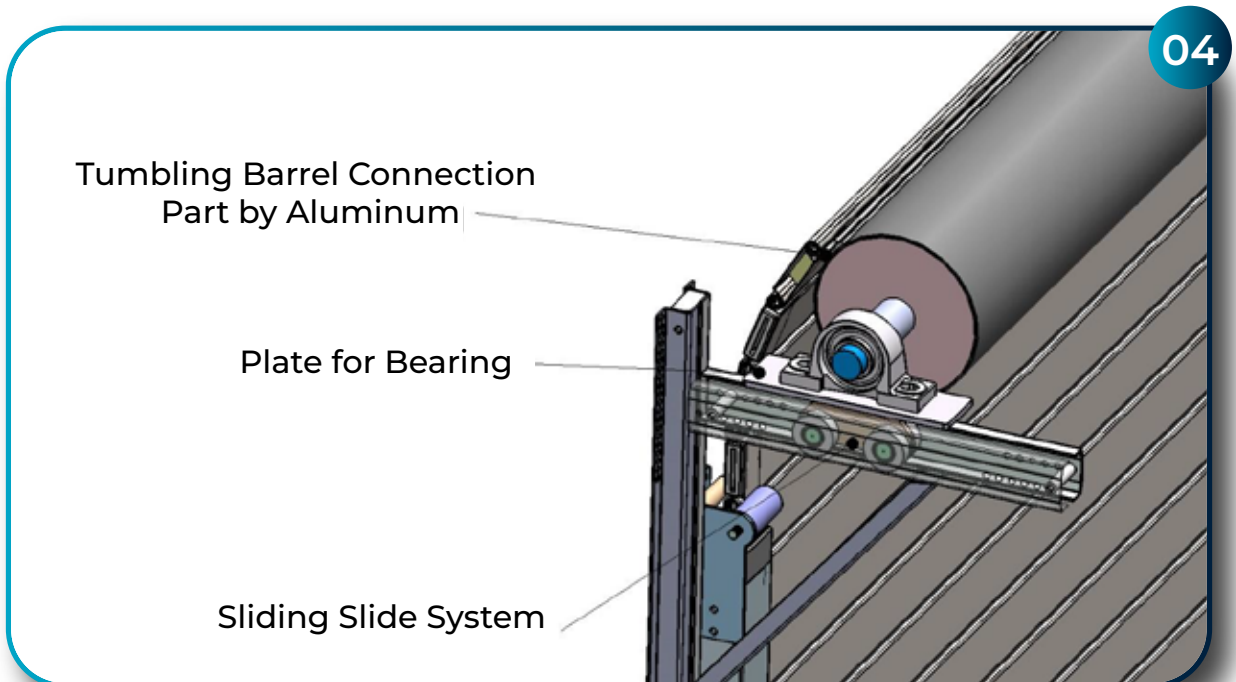
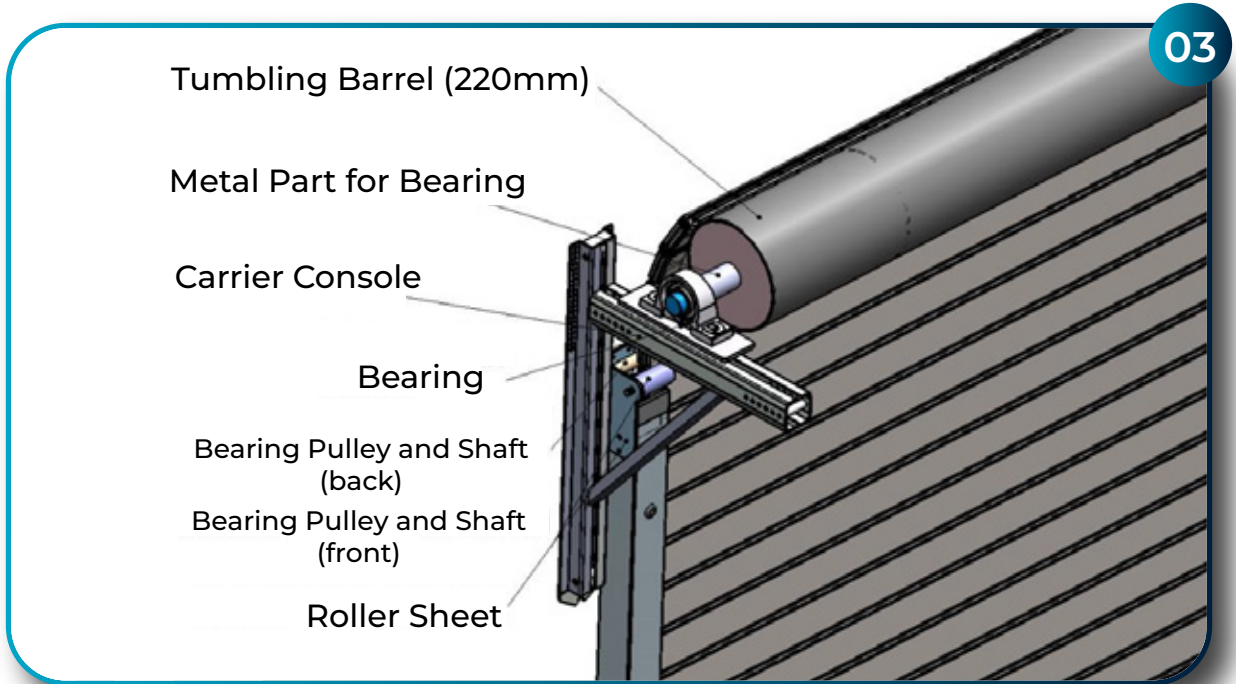



Material Explanation

05

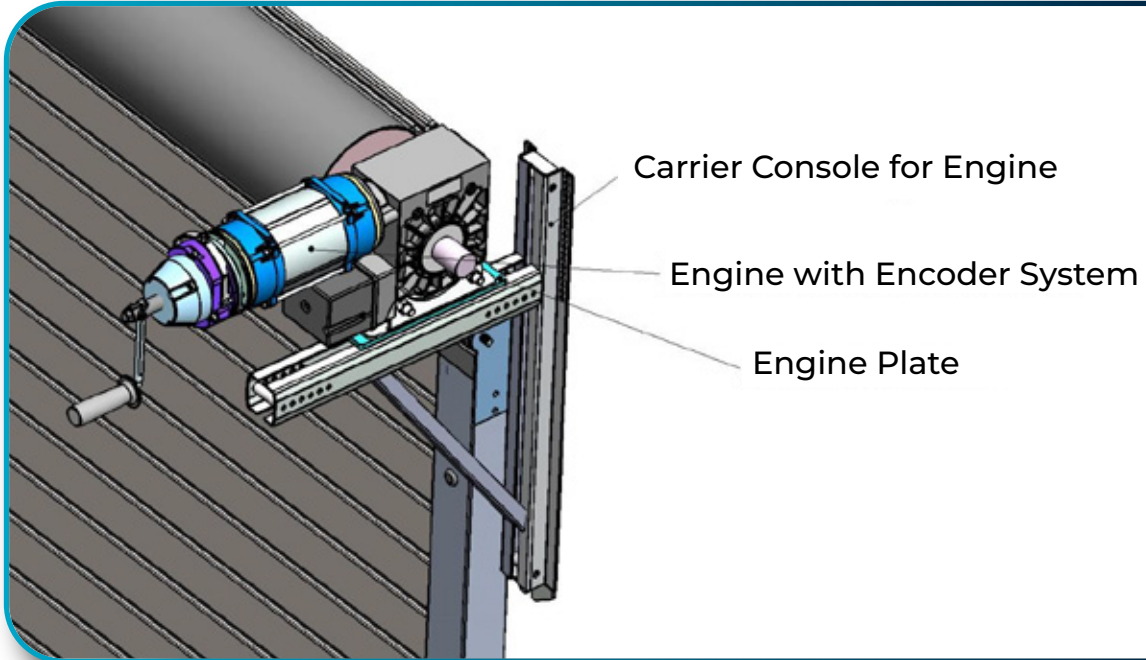

06

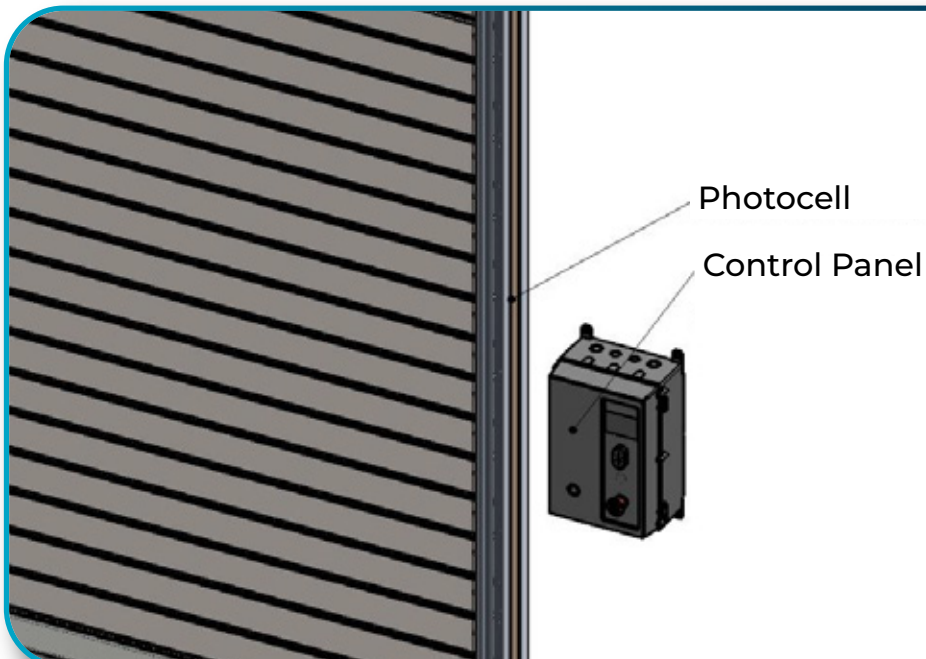



Additional Features

If the Window Required

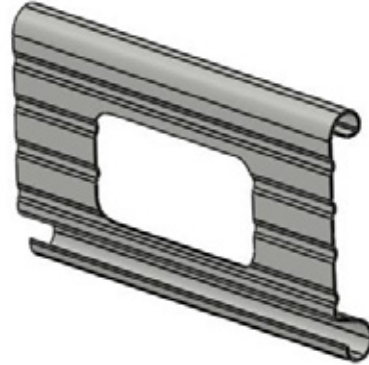
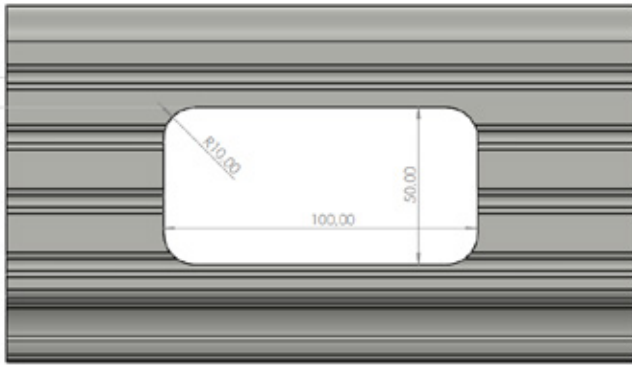

01

Windows can be opened on double-walled aluminium panels with a width and height of 100x50 mm, at regular intervals depending on the length of the panel.

In this way, it is possible to illuminate the desired number of panels in places where a transparent appearance is desired.

Wind Lock System

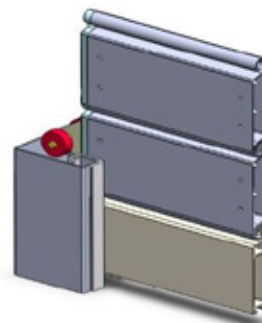
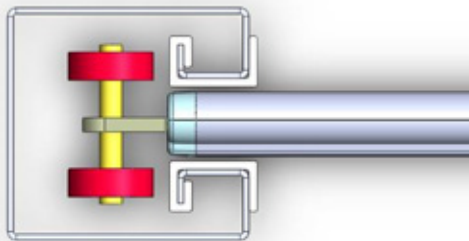

02

The system, which can be applied according to wind and pressure conditions, holds the extra bearing wheels used thanks to the form of the guides and is applied as a strength increasing system.



Wiring Diagram

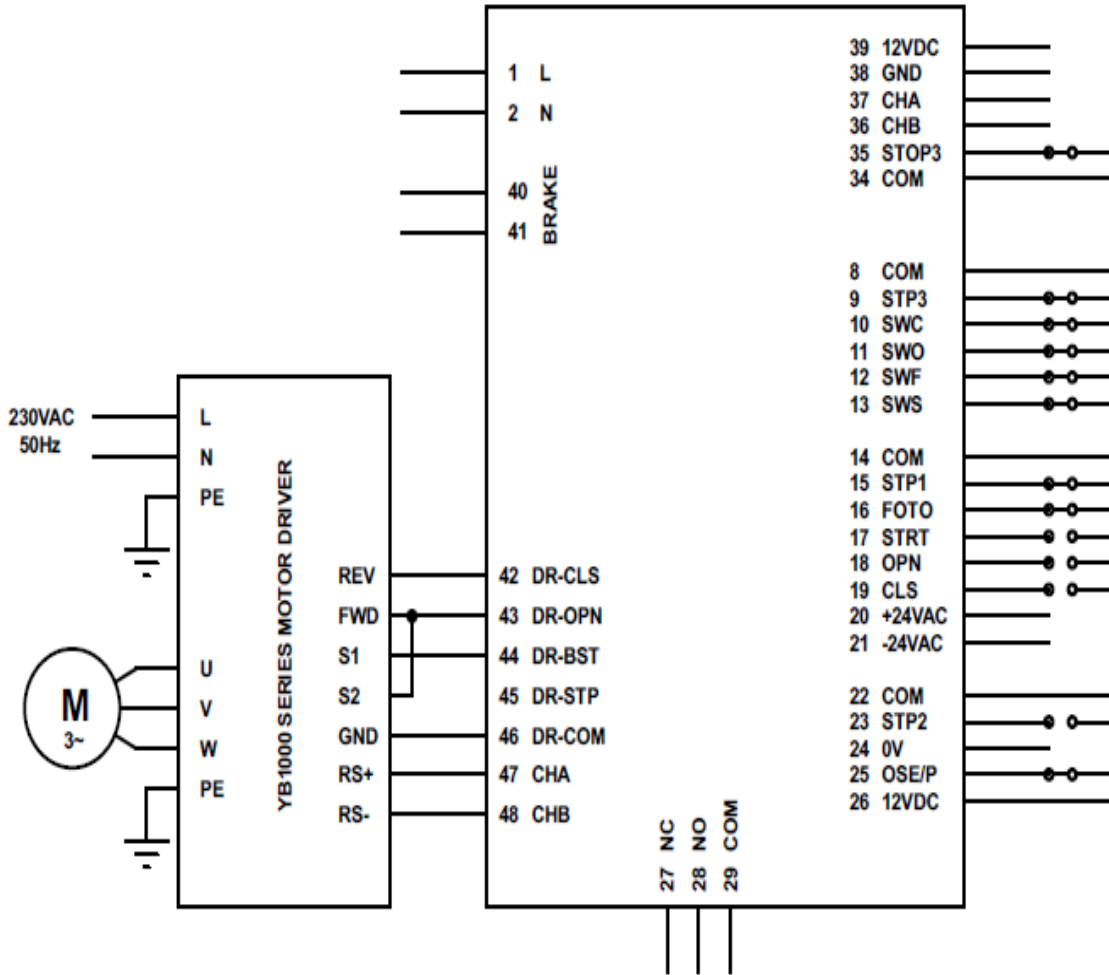

Scan the QR code to access the panel user manual and parameter setting menu.

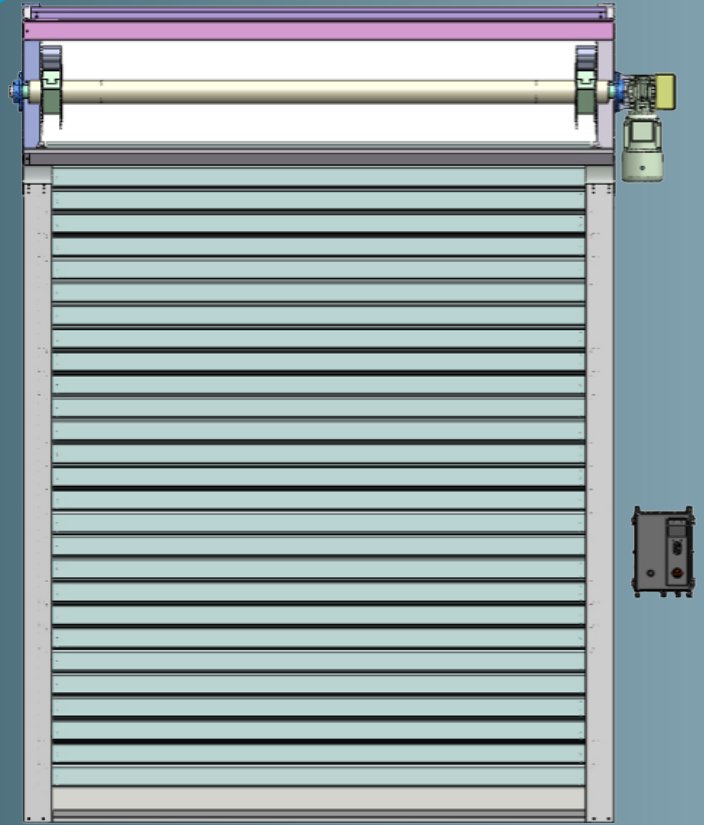

RAYFLEX[®] 
High Speed Door Technologies

SPACE300 SPIRAL DOOR



Technical Specifications

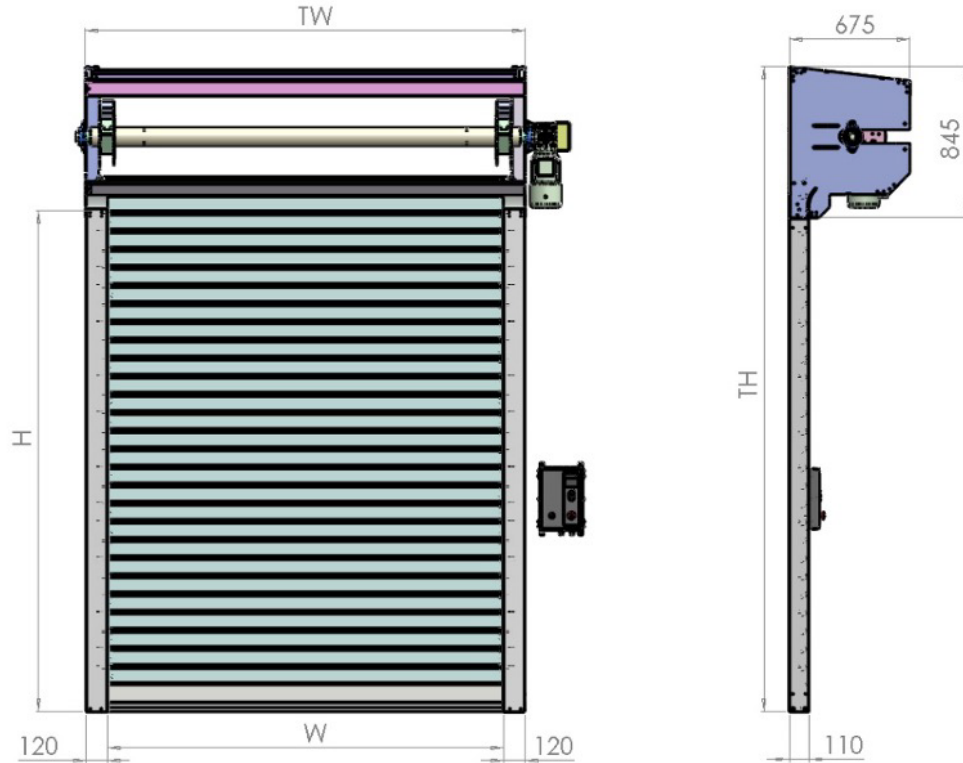

Security - Extraordinary quick spiral doors – At one door

Areas of use: Indoor and outdoor areas

Metal parts: It has a galvanized pillar with the size of 120 mm wide and it has a special form intervention covers. Also, there is a PVC wick and panel bearing wedge to prevent friction.

Panel: Panel are made by double-walled aluminum panels filled with rock wool and it has 100 mm wide and 22 mm deep

Engine: PGR Arçelik engine 0,75 kw-1,5 kw-2,2 kw
(It will vary depending on the size.)

Control panel: 30x40 plastic buat rf10 speed drive control panel (yilmaz) (380-380v resistant) – frequency value: 50-60 hz

Security system: Cedes light barrier

Limit system: Rayflex switch system with encoder



SPACE300

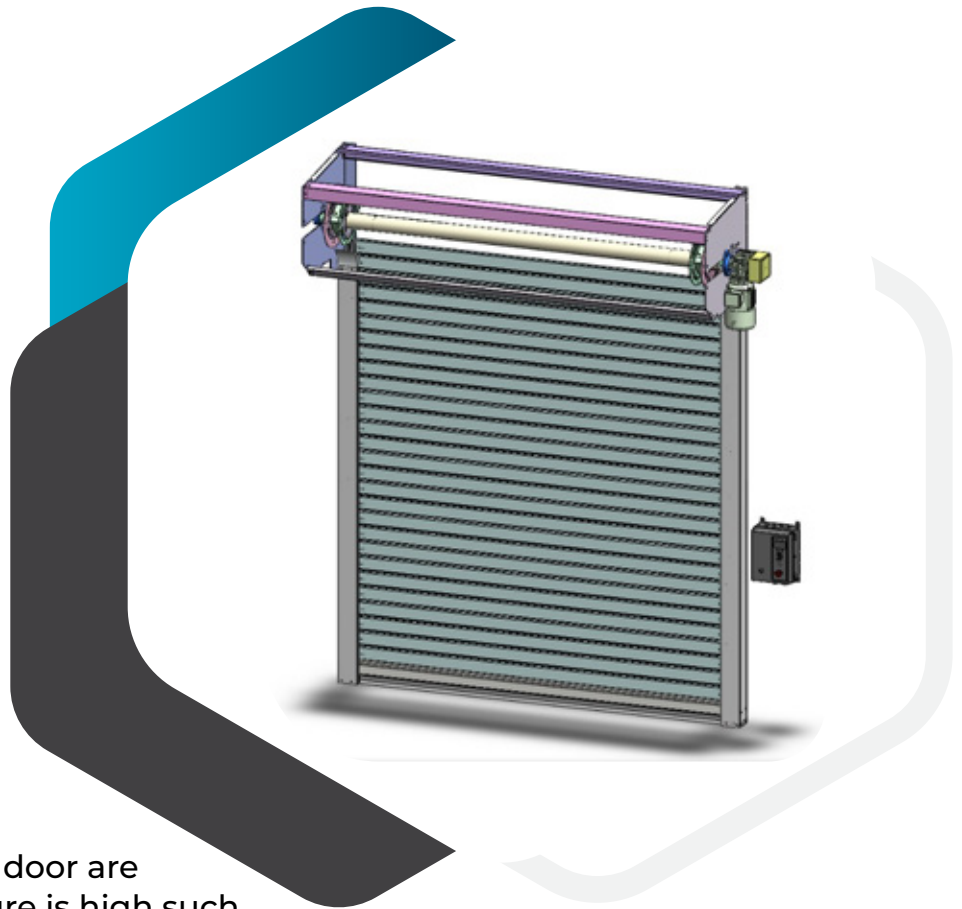

- Space300 fast aluminium door are used where the wind pressure is high such as garage doors, elevators doors, oven cabins etc.
- It provides efficiency to the clients because of the opening and closing speed and it provides insulation.
- Space300 will take your appearance and efficiency to the next level because of the spectacular looks that space300 have.
- The pillars have special PVC wicks and these wicks prevent the aluminum panels from rubbing against the metal. Also, the door works very quietly because of wicks.
- The panels are made on a special rollform machine. The production is completed by interlocking double-wall panels (1 mm thick).
- The polyurethane printing process are made by double-walled panels taken from the rollform machine. That increasing the strength of the double-walled panel. (If the door used in front of the oven cabin, the double-wall are produced by rock wool filling.)
- The flags had the cutting process on the laser machine. According to the size, the flag group (3 to 5 mm) on which the shaft group is assembled.
- The plugs used on the edges of the panels are designed to interlock. In this way, friction is prevented because distance is created between the panels.



Panel Structure

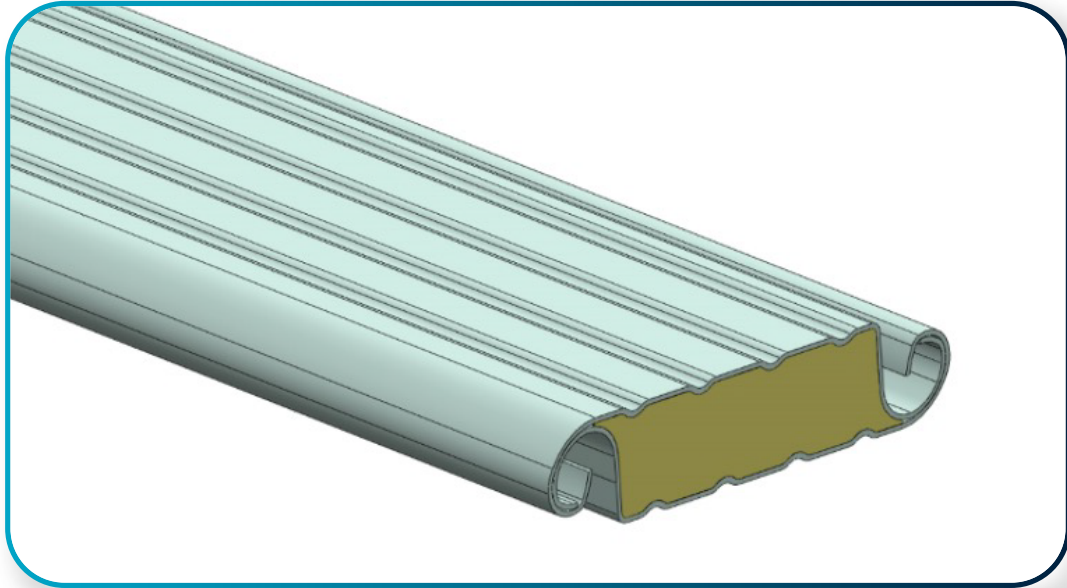

Panel Size Details

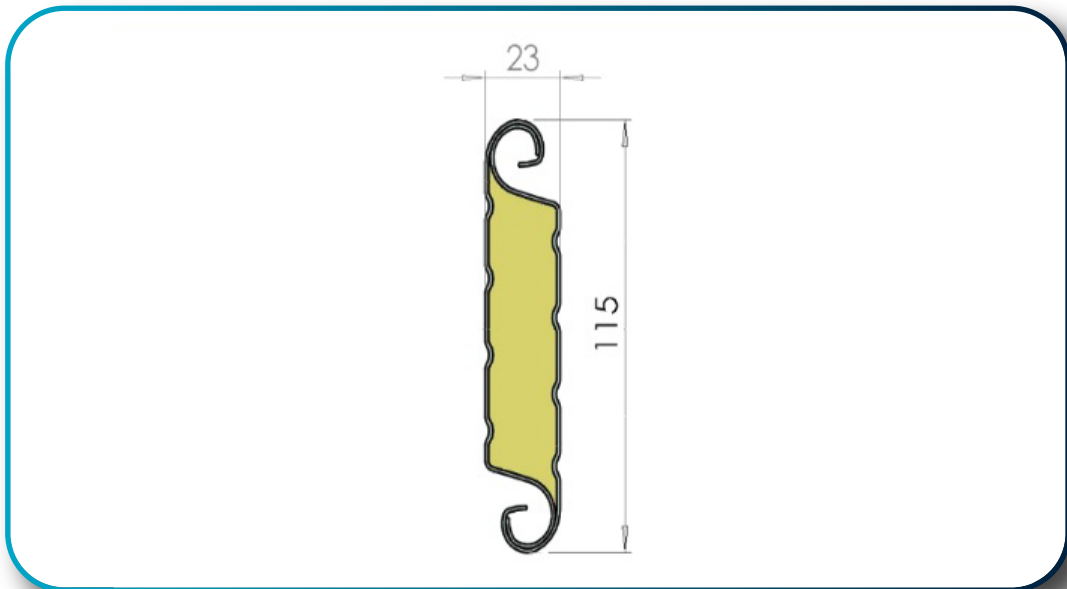



Material Explanation

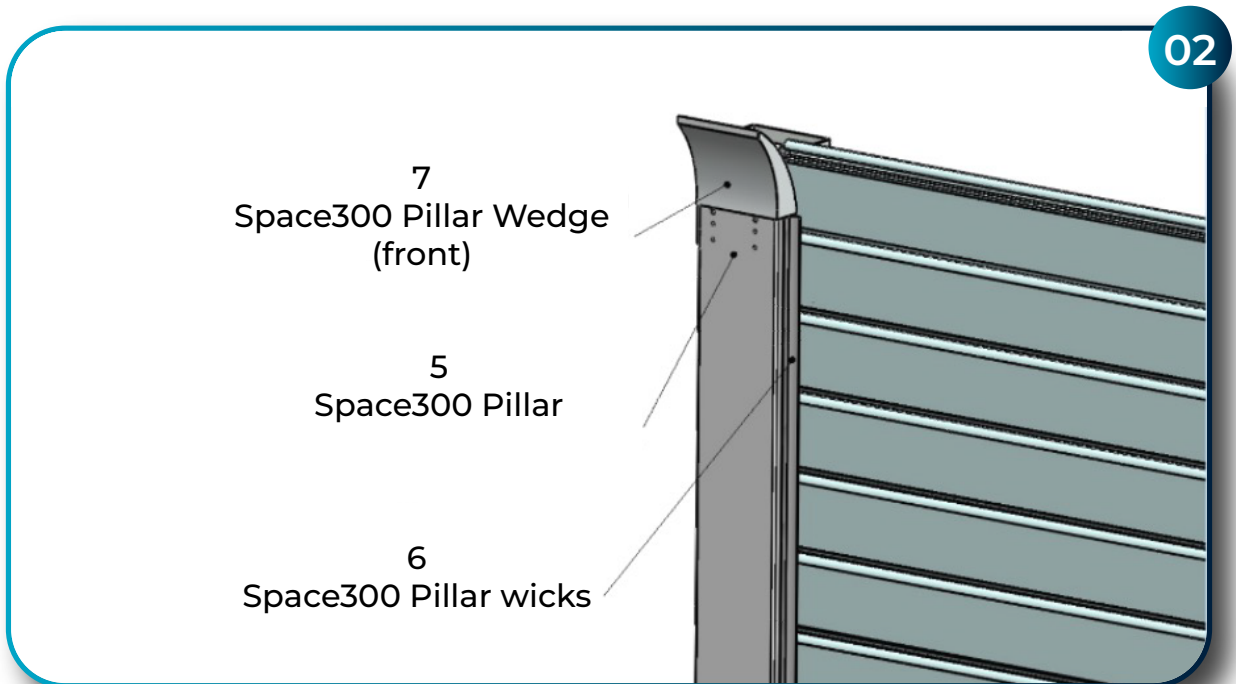
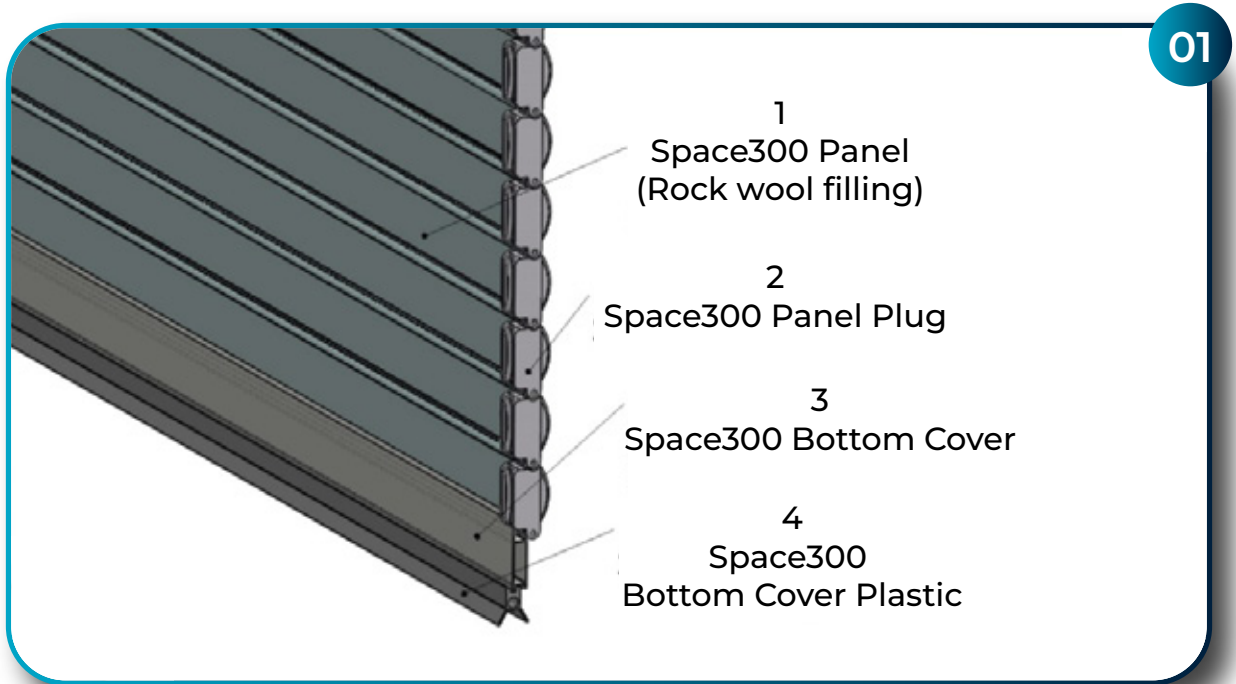



Material Explanation

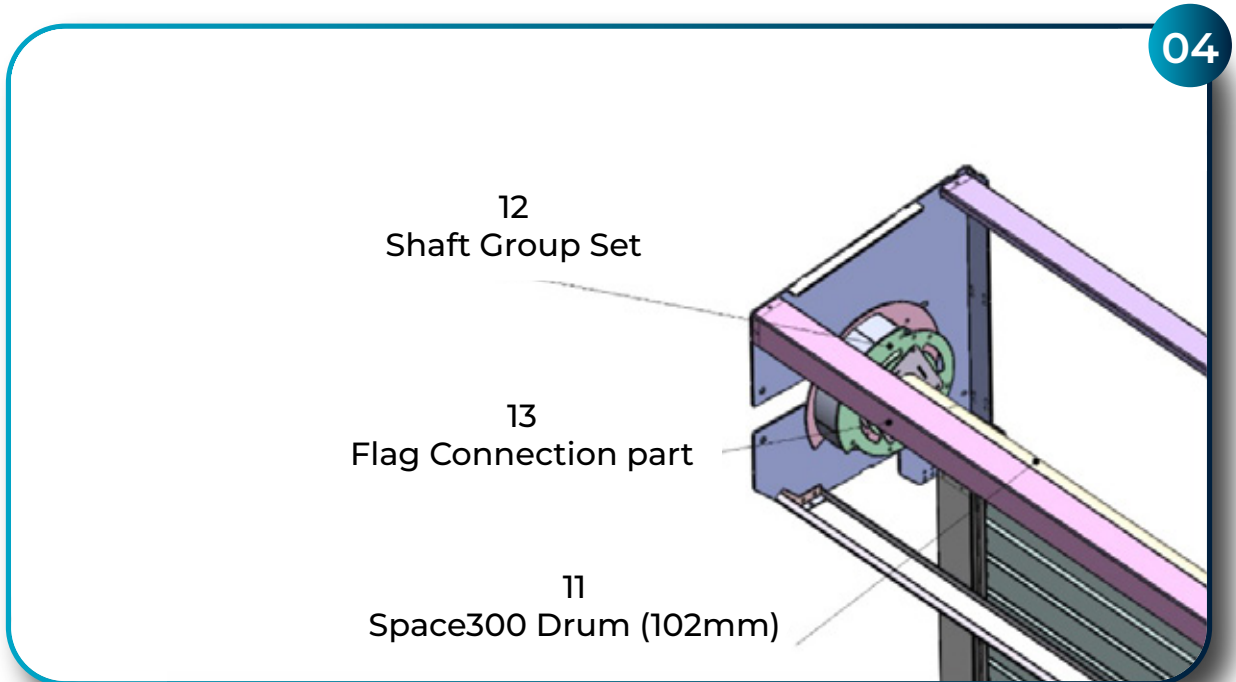
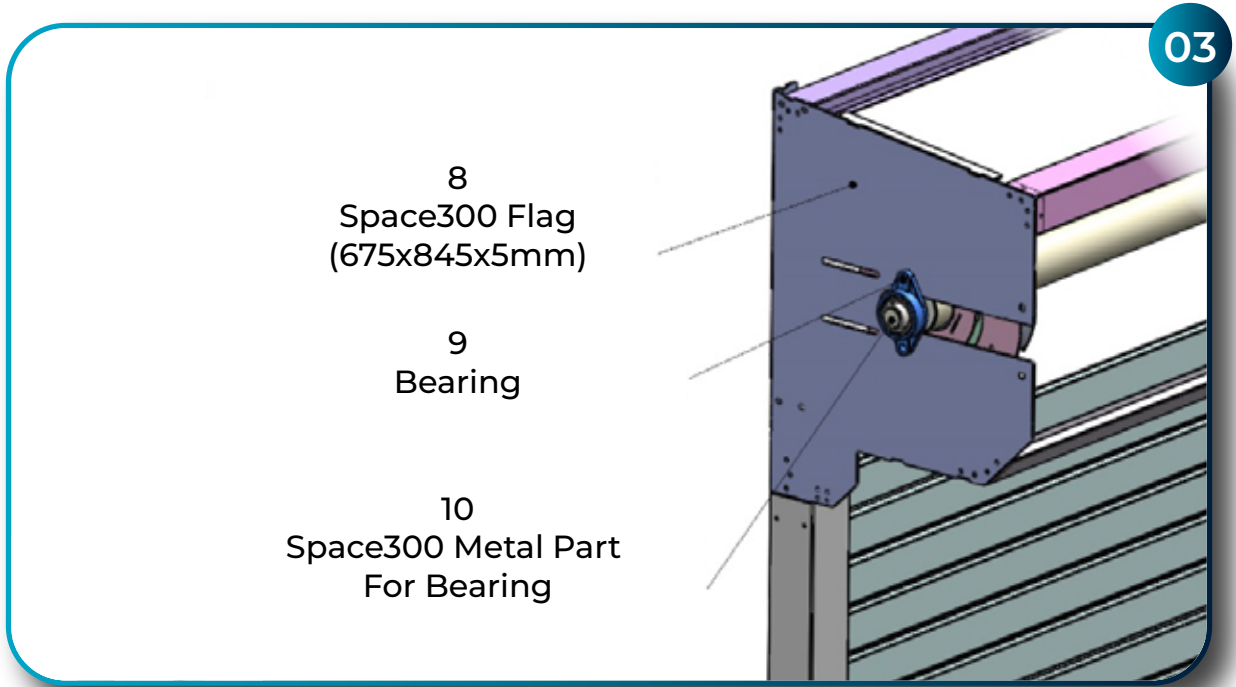



Material Explanation

05

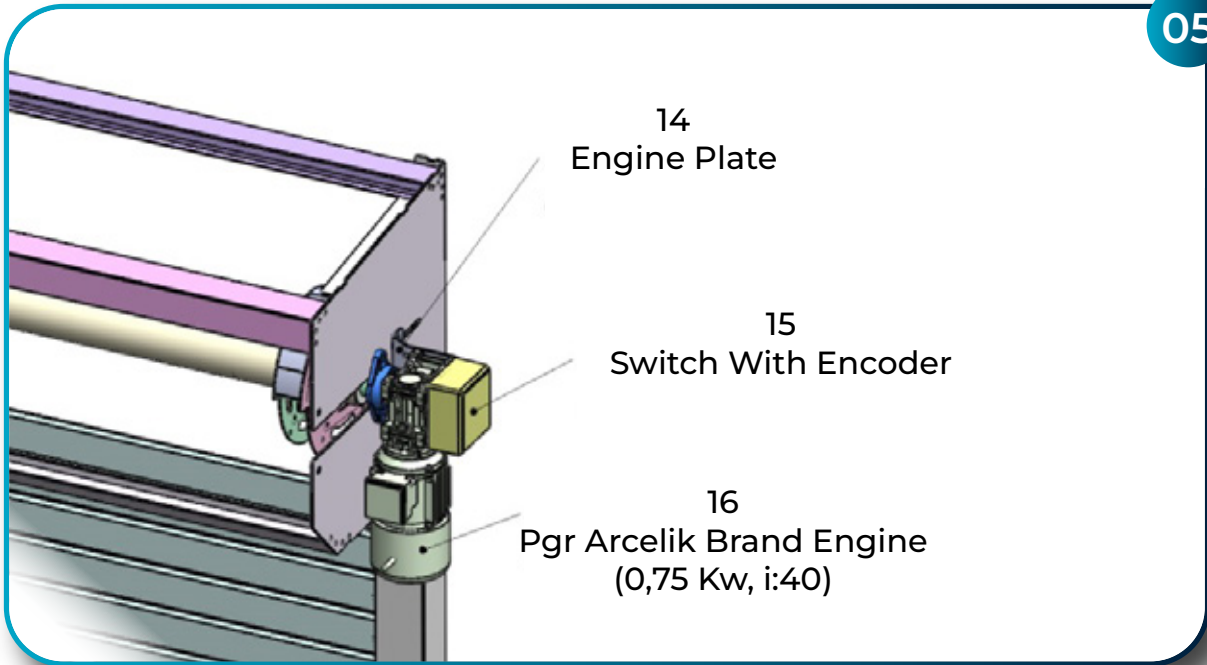

06

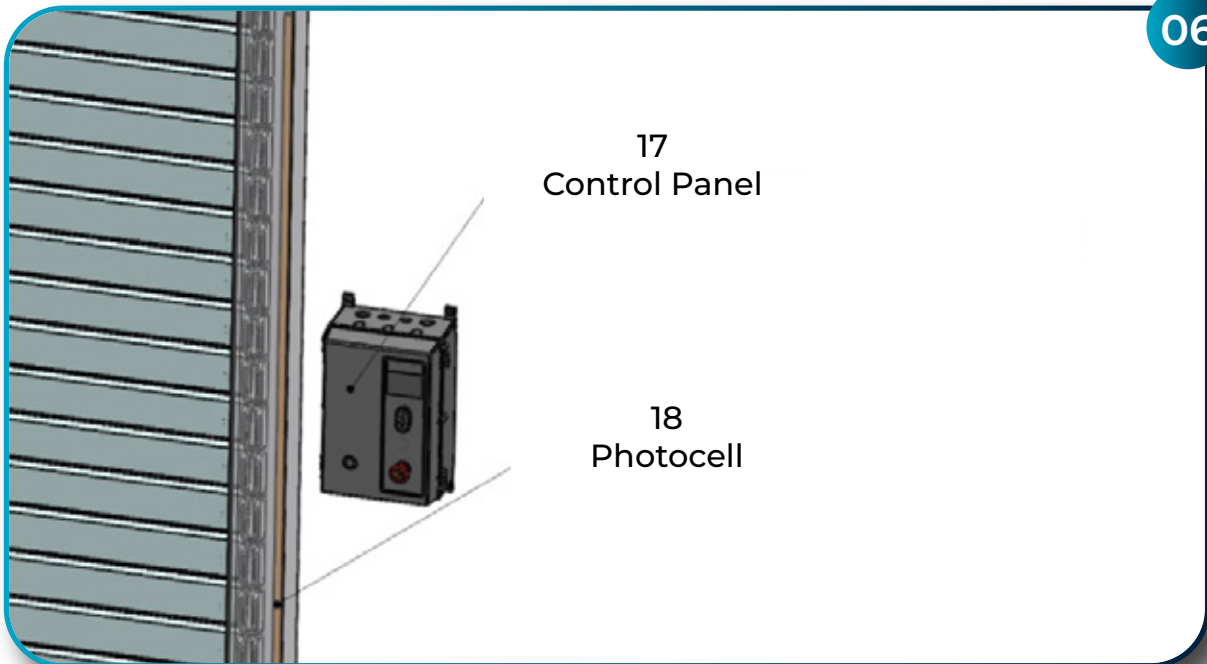



Additional Features

If the Window Required

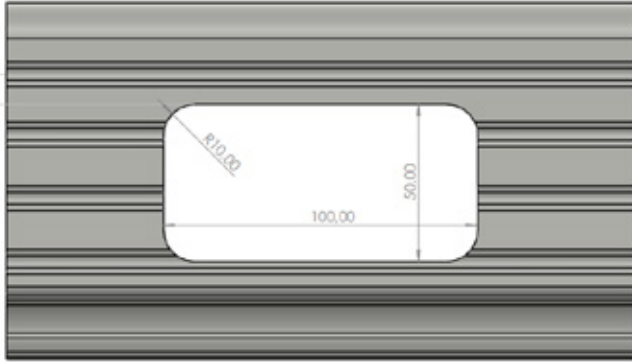

01

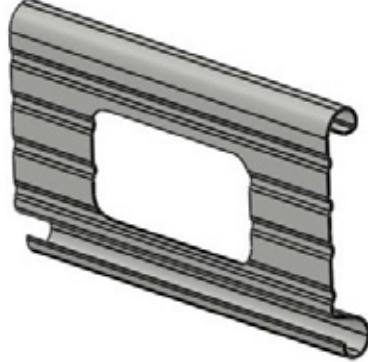

Windows can be opened on double-walled aluminium panels with a width and height of 100x50 mm, at regular intervals depending on the length of the panel.

In this way, it is possible to illuminate the desired number of panels in places where a transparent appearance is desired.

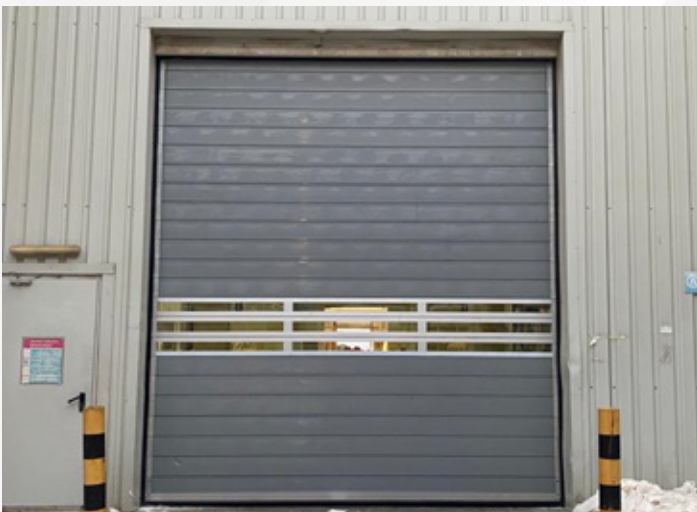
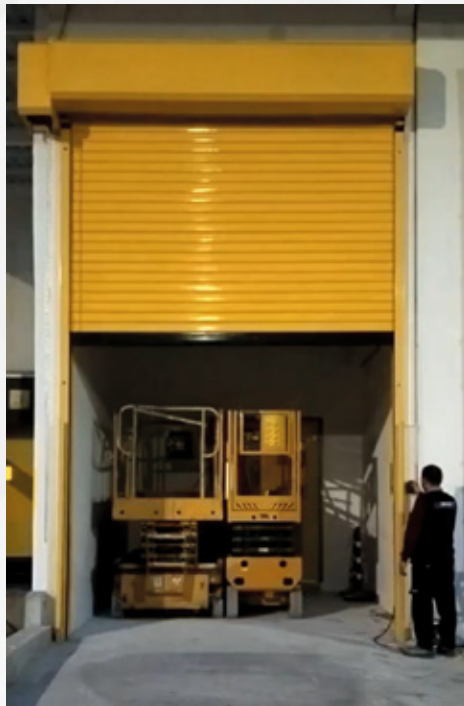



RAYFLEX

Contact Us

*“Speeds Up
Your Business...”*

Phone: +90 224 216 18 57

Web: www.rayflex.com.tr

E-Mail: info@rayflex.com.tr

Address: Tahtalı Mah.Yaylacık Yolu cd. No:41

Nilüfer / BURSA / TURKEY